



The following Motion and Document was considered by the GFC Facilities Development Committee at its July 26, 2012 meeting:

---

Agenda Title: **Gathering Place – Functional Programme and Site Study**

APPROVED MOTION: THAT the GFC Facilities Development Committee approve, under delegated authority from General Faculties Council and on the recommendation of Planning and Project Delivery, the proposed Gathering Place – Functional Programme (as set forth in Attachment 2), excluding specifics related to the siting of this facility, as the basis for further planning.

Final Amended Item: [4](#)

---

FINAL Item No. 4

**OUTLINE OF ISSUE**

Agenda Title: **Gathering Place – Functional Programme and Site Study**

**Motion:** THAT the GFC Facilities Development Committee approve, under delegated authority from General Faculties Council and on the recommendation of Planning and Project Delivery, the proposed Gathering Place – Functional Programme (as set forth in Attachment 2), excluding specifics related to the siting of this facility, as the basis for further planning.

**Item**

Action Requested	<input checked="" type="checkbox"/> Approval <input type="checkbox"/> Recommendation <input type="checkbox"/> Discussion/Advice <input type="checkbox"/> Information
Proposed by	Don Hickey, Vice-President, Facilities and Operations; Bart Becker, Associate Vice-President (Facilities and Operations);
Presenters	Ben Louie, University Architect, Planning and Project Delivery, Facilities and Operations Shana Dion, Director, Aboriginal Student Services Centre Tracy Bear, Special Advisor to the Provost, Office of the Provost and Vice-President (Academic)
Subject	Gathering Place – Functional Programme and Site Study

**Details**

Responsibility	Vice-President (Facilities and Operations)
The Purpose of the Proposal is (please be specific)	To obtain approval for the Functional Programme and Site Selection for the Gathering Place.
The Impact of the Proposal is	To provide further planning, funding application and fundraising efforts towards the realization of constructing a Gathering Place on campus in support of the Comprehensive Institutional Plan.
Replaces/Revises (eg, policies, resolutions)	n/a
Timeline/Implementation Date	n/a
Estimated Cost	n/a
Sources of Funding	n/a
Notes	n/a

**Alignment/Compliance**

Alignment with Guiding Documents	Dare to Discover; Academic Plan (Dare to Deliver); Capital Plan; Budget; Long Range Development Plan, Comprehensive Institutional Plan (CIP)
Compliance with Legislation, Policy and/or Procedure Relevant to the Proposal (please quote legislation and include identifying section numbers)	<b>1. Post-Secondary Learning Act (PSLA):</b> The PSLA gives GFC responsibility, subject to the authority of the Board of Governors, over academic affairs (Section 26(1)) and provides that GFC may make recommendations to the Board of Governors on a building program and related matters (Section 26(1) (o)). Section 18(1) of the PSLA give the Board of Governors the authority to make any bylaws “appropriate for the management, government and control of the university buildings and land.” Section 19 of the Act requires that the Board “consider the recommendations of the general faculties council, if any, on matters of academic import prior to providing for (a) the support and maintenance

FINAL Item No. 4

	<p>of the university, (b) the betterment of existing buildings, (c) the construction of any new buildings the board considers necessary for the purposes of the university [and] (d) the furnishing and equipping of the existing and newly erected buildings [...] [...]"</p> <p>Section 67(1) of the <i>Act</i> governs the terms under which university land may be leased.</p> <p><b>2. GFC Facilities Development Committee (FDC) Terms of Reference – Section 3. Mandate of the Committee:</b> “[...]”</p> <p>2. Delegation of Authority</p> <p>Notwithstanding anything to the contrary in the terms of reference above, the Board of Governors and General Faculties Council have delegated to the Facilities Development Committee the following powers and authority:</p> <p><b>A. Facilities</b></p> <p>1. To approve proposed General Space Programmes (Programs) for academic units.</p> <p>2. (i) To approve proposals concerning the design and use of all new facilities and the repurposing of existing facilities and to routinely report these decisions for information to the Board of Governors.</p> <p>(ii) In considering such proposals, GFC FDC may provide advice, upon request, to the Provost and Vice-President (Academic), Vice-President (Facilities and Operations), and/or the University Architect (or their respective delegates) on the siting of such facilities. (GFC SEP 29 2003)</p> <p><b>B. Other Matters</b></p> <p>The Chair of FDC will bring forward to FDC items where the Office of the Provost and Vice-President (Academic) and/or the Office of the Vice-President (Facilities and Operations), in consultation with other units or officers of the University, is seeking the advice of the Committee.</p> <p><b>3. UAPPOL Space Management Policy and Space Management Procedure:</b> The respective roles of GFC FDC and the Vice-President (Facilities and Operations) with regard to institutional space management are set out in this Board-approved Policy and attendant Procedure.</p> <p>To access this policy suite on line, go to: <a href="http://www.uappol.ualberta.ca">www.uappol.ualberta.ca</a> .</p>
--	---

**Routing** (Include meeting dates)

<p>Consultative Route (parties who have seen the proposal and in what capacity)</p>	<ul style="list-style-type: none"> <li>• University of Alberta Aboriginal Advisory Council – 1998</li> <li>• Aboriginal Strategies Task Force - 2001</li> <li>• Indigenous Centre Committee - 2002</li> <li>• The Aboriginal Gathering Place Visioning Process (Visioning Session – April 7, 2008 and Programming Session – September 4, 2008 with key stakeholders from the University of Alberta, the Aboriginal Initiative Working Group, Elders, Faculty, and Student representative)</li> <li>• University of Alberta Aboriginal Gathering Place – Visioning and</li> </ul>
---	--



FINAL Item No. 4

	Programming Study (May 2009) <ul style="list-style-type: none"><li>• This study was presented to the Council of Aboriginal Initiatives by Tracy Bear, Shana Dion, and Ben Louie on May 1, 2012.</li></ul>
Approval Route (Governance) (including meeting dates)	GFC Facilities Development Committee – July 26, 2012 (for approval)
Final Approver	GFC Facilities Development Committee

Attachments:

1. Attachment 1 (Pages 1-2) Briefing Note - Gathering Place – Functional Programme and Site Study
2. Attachment 2 (Pages 1-81) Gathering Place - Functional Programme and Site Study Report

*Prepared by:*

Ben Louie, University Architect,  
Planning and Project Delivery (Facilities and Operations)

## **Planning and Project Delivery**

### **Gathering Place – Functional Programme and Site Study**

#### **Background**

It is the intention of the University of Alberta to build a place of hope for Indigenous peoples on our campus. The vision for the Gathering Place is to provide a foundation for education, research and community engagement for Indigenous people of all ages - providing leadership development for a significant generation of Alberta's youth. From that foundation, the hope they build will transform their futures, and ours.

The Gathering Place will affirm the cultural identity of this important next generation of Indigenous youth, and allow all students, faculty and the wider community to share in the culture and values that distinguish Indigenous society. It will be a symbol of good will, unity and intersection.

Open to the greater University body, the Gathering Place will function as a cross-faculty centre of learning in order to facilitate a higher quality of dialogue between Aboriginal students and staff and all Academic disciplines at the University of Alberta.

The journey of the Gathering Place has been guided and shaped by the efforts and wisdoms generated by members of past committees:

- University of Alberta Aboriginal Advisory Council – 1998
- Aboriginal Strategies Task Force – 2001
- Indigenous Centre Committee – 2002
- The Aboriginal Gathering Place Visioning Process – 2008
- University of Alberta Aboriginal Gathering Place – Visioning and Programming Study (May 2009)

In addition, it has been shaped by direct operational input from the following places:

- Migizii Agamik (Bald Eagle House), University of Manitoba
- First Peoples House of Learning, Trent University
- First Nations House of Learning, University of British Columbia
- First People's House, University of Victoria
- Shq'aphthut (Gathering Place in Hul'q'umi'num), Vancouver Island University

#### **Issues**

The purpose of this study is to redefine the scope and planning strategy to respond to the proposed site for the facility in the heart of the north campus, directly north of the Education Building. In this location, the Gathering Place is able to benefit from synergies with amenities and support spaces existing in the North Education Building while providing an opportunity to create the necessary amenities and resources for Aboriginal students.

## **(Gathering Place – Functional Programme and Site Study)**

The Functional Programme and Site Study document focuses on the following aspects:

- Cultural Background / Significance of the Project
- Building Programme
- Site Planning Parameters
- Architectural Design Parameters
- Preliminary Project Budget

### **Recommendation**

The proposed Gathering Place – Functional Programme and Site Study Report be approved as the basis for further planning.

UNIVERSITY OF ALBERTA  
GATHERING PLACE

12-012  
July 26, 2012

F U N C T I O N A L   P R O G R A M M E   A N D   S I T E   S T U D Y

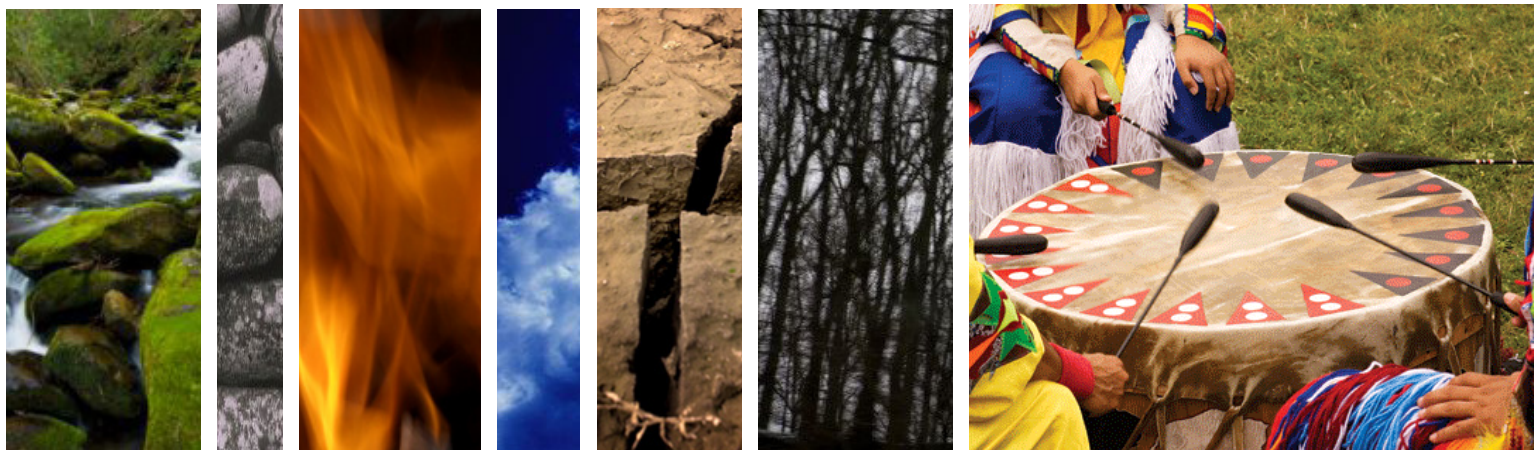





## INTRODUCTION

- 1.0 Functional Programme
  - 1.1 Programme Descriptions
  - 1.2 Programme Area and Programme Synergies
- 2.0 Site Characteristics
  - 2.1 Site Context
  - 2.2 Site Photos
  - 2.3 Pedestrian & Traffic Plans
  - 2.4 Existing Nodes Plan
- 3.0 Precedent Study
  - 3.1 Natural Parallels
  - 3.2 Dynamic Interior/Exterior Relationships
  - 3.3 Light and Transparency
  - 3.4 Connection to Outdoors
- 4.0 Functional Plans
  - 4.1 Proposed Site Plan
  - 4.2 Programme Relationship Study
  - 4.3 Gathering Place Floor Plans
  - 4.4 North Education Building Synergies and Floor Plans
- 5.0 Concept Images
- 6.0 Appendix
  - 6.1 Council on Aboriginal Initiatives (CAI) and Steering Committee Membership Teams
  - 6.2 Acknowledgments – University of Alberta Gathering Place Visioning and Programming Study 2009
  - 6.3 PowerPoint Presentation – Lessons Learned
  - 6.4 Preliminary Budget – RESERVED



## INTRODUCTION

The University of Alberta is in the business of hope. Education, research and community engagement are the conduits through which the hope we broker enacts itself in our immediate and global communities. It is our intention to build a place of hope for Indigenous peoples on our campus. This place, the Gathering Place, will provide leadership development for a significant generation of Alberta's youth. It will also celebrate the important past and future value that Indigenous culture and people contribute to the community. Our vision is for the Gathering Place to provide a foundation for education, research and community engagement for Indigenous people. From that foundation, the hope they build will transform their futures, and ours.

The conceptual design we share today is the distillation of these past discussions/dialogues respecting and honouring the time and effort of everyone who participated in the many discussions and studies. The current conceptual design also factors in these dynamics; the location and budget change; the Gathering Place Update & Holiday Luncheon blessing; and the Gathering Place scouting trip report.

With our combined experience and knowledge relating to the specific barriers facing Indigenous students and the past visioning work of Elders, staff, faculty and community members resounding in our minds we have been able to distill all of this knowledge. Finally, considering all of these factors and through a series of lively discussions with Ben Louie and Group2- Architecture Interior Design Group, we are confident that this design will,

*"Become a place of welcome, a place of understanding, a place of cultural connection and a place that creates opportunities for Aboriginals and non-Aboriginal peoples near and far to learn, to grow, and to celebrate together".* Indira Samarasekera, o.c., President and Vice-Chancellor.

Cultural affirmation is a powerful tool in the development of leadership. It provides the self-confidence for people to envision themselves as leaders, and then to define and pursue positive leadership roles for themselves. The Gathering place will affirm the cultural identity of multi-generation Indigenous students, and allow all students, faculty and the wider community to share in the culture and values that distinguish Indigenous society. It will be a symbol of good will, unity and intersection.

The Gathering Place will be a showcase for Indigenous culture. The University of Alberta's significant Indigenous art and anthropological holdings will find a home, and people can engage in Indigenous art and music. Gathering, sharing of culture and inclusiveness will be central themes. A Great Hall and outdoor gathering space, as well as smaller, informal meeting spaces will be available to the entire campus and wider community to hold important educational, special, celebratory and ceremonial events. Aboriginal student services and administration, student groups, housing and tutoring services will be located in this rich environment.

Through this place, this Gathering Place we will then finally achieve President Samarasekera's vision to provide:

"Increasing support for programs, resources and support systems that will enable Aboriginal youth to discover their talents, develop their skills and leadership abilities and prepare them for success is one of our University's main priorities. We aim to be the University of Choice for Indigenous peoples in Canada." Indira Samarasekera, o.c., President and Vice-Chancellor.

#### INCORPORATION OF U-SCHOOL:

U-School is a significant time for University of Alberta. The campus welcomes over 800 students from schools with vulnerable populations to come to 'school' at the University for a week. We know it is critical for students to begin to think about PSE as early as grades 5, 6 & 7. Hosted by the Chancellor, supported by the Senate and funded by the University, students have the unique opportunity to engage with scholars and staff on campus. Located in the heart of campus, the Gathering Place will host and house these students in their own U-School classroom for use Monday to Friday 15 to 25 weeks of the year.

The purpose of this study is to redefine the scope and planning strategy to respond to the proposed site for the facility in the heart of the south campus directly north of the Education Building. In this location The Gathering Place is able to benefit from synergies with amenities and support spaces existing in the North education Building while providing an opportunity to create the necessary amenities and resources for Aboriginal students.

The document focuses on the following aspects:

- Cultural Background / Significance of the Project
- Building Programme
- Site Planning Parameters
- Architectural Design Parameters
- Preliminary Project Budget

The journey of The Gathering Place has been guided and shaped by the efforts and knowledge generated by members of past committees;

- University of Alberta Aboriginal Advisory Council -1998
- Aboriginal Strategies Task Force – 2001
- Indigenous Centre Committee – 2002
- The Aboriginal Gathering Place Visioning Process (Visioning Session - April 7, 2008 and Programming Session - September 4, 2008 with key stakeholders from the University of Alberta, the Aboriginal Initiative Working Group, Elders, Faculty, and Student representatives)
- University of Alberta Aboriginal Gathering Place - Visioning and Programming Study (May, 2009)

It has also been shaped by direct operational input of Tracy Bear and Shana Dion who have toured other similar facilities at:

- Migizii Agamik (Bald Eagle House), University of Manitoba, Winnipeg MB
- First Peoples House of Learning, Trent University, Peterborough ON
- First Nations House of Learning, University of British Columbia, Vancouver BC
- First Peoples House, University of Victoria, Victoria BC
- Shq'aphthut (Gathering Place in Hul'q'umi'num), Vancouver Island University, Nanaimo BC

This study was presented to the Council of Aboriginal Initiatives by Tracy Bear, Shana Dion and Ben Louie on May 1, 2012 and received helpful comments and favourable support from co-chairs and member of the Council.





## 1.0 FUNCTIONAL PROGRAMME

### 1.1 PROGRAMME DESCRIPTIONS

The building programme has been developed around six primary categories of space:

- Cultural
- Common Areas
- Knowledge / Resource Centre
- Administrative
- Building Services
- Outdoor Spaces

The primary focus of the Gathering Place will be around the Cultural functions provided for the Aboriginal students including their communities, the University of Alberta, and the greater Community at large. Other spaces within the Gathering Place provide ancillary functions which support this objective. As well, the Gathering Place will be open to the greater University body, functioning as a cross-faculty centre of learning in order to facilitate a high quality of dialogue between Aboriginal students and staff, and all Academic disciplines at the University of Alberta.

## I. CULTURAL SPACE

Traditional ceremonies are vital to Aboriginal culture. While differing in size and scope, ceremonial celebrations can range from the spirit world to social occasions. They can be held to honour the way of life, the past, the future, the human spirit, mother earth, birthdays, etc. and are the primary facet of tribal life for many Aboriginal people.

The concept of ceremony is important when considering specific functions to be housed within the Gathering Place; indeed, this concept lies at the heart of the building. Its purpose is to bring people together in encouragement and understanding through cultural experiences which began to define the programming concept for the Central Gathering Space, focusing on a functional size capable of being utilized for various sized functions and events.

The incorporation of other cultural areas such as Student Gathering, Gallery / Exhibition and Multi-Functional spaces are located adjacent or in proximity to the Central space, allowing for flexibility in the coordination of activities and events of varying size and capacity. This strategy promotes continual daily use of the facility by cross faculty users, rather than creating a single oversized Central Space that is used sporadically throughout the year.





Descriptions of the main building functions are as follows:

## I. CULTURAL SPACE

### **Great Hall** – (4,575sq.ft. / 425m2) Formerly Central Gathering Space

This ceremonial space will be the central focus of the Gathering Place, capable of holding +/-250 people for a wide variety of events. Events will include but not limited to community gatherings such as feasts, round dances, lectures, plays, social gatherings, and political functions. Currently, there is no intention of using this space as a venue for sports activities, as athletic facilities already exist on campus.

**Primary Adjacencies:** Kitchen/Great Eastern Door/Elders Meeting room/office space/Coat room

**Secondary Adjacencies:** Washrooms

**Workshop feedback:** Acoustics are a critical aspect of this space. It must be designed to account for round dances and drumming. Likewise, natural light is important. The space should open out to the Outdoor Gathering Space during events having large group participation.

**Scouting Trip Results:** Changes to workshop feedback - U of A Round dances have grown to host 1200 participants. It is not useful to build and use up valuable footage for a space/room that would hold everyone for a yearly event. The Great Hall should have capability to have a sacred fire. The fire should be contained in a specialized fireplace that is sunk into the floor. Flooring will cover the sacred fire when the fireplace is not being utilized, which will enable the entire space to be accessible. The Great Hall will be adjacent to the industrial kitchen for feasts, the Elders office/meeting room and outdoor space. As well as having accessibility through the north entrance, it is imperative there also be Great Doors opening up to the Eastern direction. Bench seating (similar to Uvic's Ceremonial Hall) should be incorporated. If available (or even invented) the sound system and/or acoustics of the Great Hall should allow everyone inside to hear the quiet prayers of Elders without white noise interference. We were advised to consult with theatre people on this point. The room will also require a built-in projection screen and projector/sound room. Lots of electrical outlets.

### **Industrial Kitchen** – 1<sup>st</sup> floor (538 sq. ft. / 50m<sup>2</sup>)

The kitchen is designed as a place of support for programming a variety of functions. It is intended to function as both a teaching kitchen and catering for building related functions and events. The teaching kitchen can be used part time as a classroom for Elders and cultural resources to teach life skills and traditional meal preparation to younger generations. The space is not intended as a commercial kitchen to be leased / operated by an independent vendor.

**Primary Adjacencies:** Great Hall/Coffee Room

**Secondary Adjacencies:** Elders Meeting room/office space/washrooms

**Workshop feedback:** N/A

**Scouting Trip Results:** An industrial kitchen is one of the most important rooms within a Gathering Space. It was evident in the difference between visited Facilities that had their Great Hall connected directly to their kitchen and facilities that did not. Kitchens that were not connected caused a lot of difficulty in preparing and serving foods. We must include ample preparation areas along with sufficient shelving and storage – these are imperative. An industrial restaurant style dishwasher is crucial. An apartment style washer/dryer will also be required.



### **Kitchen Storage** – 1<sup>st</sup> floor (108 sq. ft. / 10m<sup>2</sup>)

This will house all associated food storage required for the kitchen. Feastware, cooking utensils, pots etc.

**Primary Adjacencies:** Loading dock, Kitchen

**Secondary Adjacencies:** Elder's office/meeting space

**Workshop feedback:** N/A

**Scouting Trip Results:** We found that storage and shelving were often overlooked and badly needed in the Gathering Spaces kitchens.

### **Entrance/Reception** – 1<sup>st</sup> floor (538 sq.ft. / 50m<sup>2</sup>)

The entrance/reception area will be used as an entry and crush space for activities taking place in all parts of the building. This area will provide the primary public access point and can also function as an orientation space for the variety of users coming to the Gathering Space daily.

**Primary Adjacencies:** Great Hall/Washrooms/Kitchen/Knowledge Commons Area

**Secondary Adjacencies:** Elder's Office/meeting areas/ 1<sup>st</sup> floor administrative offices.

**Workshop feedback:** Informal areas are required within the building where people can break away from larger group(s) and meet. At many larger venues (hotels) this is done in the corridors/ lobby area. Having this area designed with spaces for these informal meetings to occur (small break out rooms) would be beneficial. Also imperative is having a friendly face to greet visitors/students/guests and offer assistance.

**Scouting Trip Results:** The Reception area was often seen as a central hub for many offices and the Great Hall, adding a friendly face to greet and assist visitors. Facilities with the reception near the back of their Gathering Place and away from their Ceremonial Space, encountered various problems with visitors getting lost or 'hanging out' in their sacred ceremonial room. This resulted in their ceremonial room being locked and inaccessible to people dropping in.

**Coat Room** – 1<sup>st</sup> floor (108 sq.ft. / 10m<sup>2</sup>)

The Coat Room will provide coat storage for large-scale functions and located off the Great Hall.

**Primary Adjacencies:** Great Hall  
**Secondary Adjacencies:** Kitchen/Elders' Offices  
**Workshop feedback:** N/A  
**Scouting Trip Results:** Can also be a transition area for women to put on their long skirts for ceremony.

**Ceremonial Room** – Included within Great Hall

**Scouting Trip Results:** No longer needed. Most ceremonies will be held in the Great Hall. For smaller, more intimate spaces used for smudging, meditating etc. the Elder's Meeting rooms or offices shall be used. At the front doors there will be smudge available for people who wish to smudge.

**Workshop feedback:** The potential for performing smudges in this interior space will need to be addressed in the design. Daylight is important, as well as cardinal directions and the orientation of the space.

**Food Service** – EXISTING SPACE IN EDUCATION BUILDING

The Food Service operation provided by the Education Building allows for a great variety of healthy options adjacent to the key areas. It's also close enough to potentially provide service for smaller group meals, luncheons etc. served in some of the new program areas.

**Workshop feedback:** The size and layout of the Food Service will depend on the final, more detailed resolution regarding how the kitchen/food service aspects of the Gathering Place are operated. (New opportunities are greatly enhanced from what was previously envisioned).

**Scouting Trip Results:** N/A The various Gathering Places had their own food service availability.

## II. COMMON AREAS

These moderately scaled spaces will accommodate functions likely to occur on a day to day basis at the Gathering Place, also providing a variety of activities that could support culturally based events.

### **Multi-Functional Classrooms** (860 sq.ft. / 80m<sup>2</sup>) – 2<sup>nd</sup> floor

Each classroom will seat 50 students comfortably and provide a space for the Transition Year students (TYP) for their daily activities and events such as tutoring and visiting lecturers/speakers events. The other classroom will be used for visiting schools from U School or Hope Camp which host elementary students on campus for week long visits. Can also be a space for Aboriginal Student Discovery Day (hosted by the Aboriginal Recruitment Coordinator), visiting lecturers, Aboriginal Education Advisors Conference, Amiqaaq2 breakout session and other seminars, workshops, classes, and presentations. Water sinks will be provided as well.

- Primary Adjacencies:** 2nd floor administrative offices/TYP Coordinator
- Secondary Adjacencies:** Rooftop
- Workshop feedback:** A desire to have a space which could provide state of the art video conferencing for larger groups was expressed.
- Scouting Trip Results:** Hosting U-School or Hope Camp here on campus is an amazing opportunity for the U of A to show off its Indigenous scholars, students and staff. There has been difficulty in booking accessible, comfortable rooms for these students. While we recognize that Education building has classrooms available, many of the more highly coveted rooms (with windows for example) are often booked far in advance by the central booking offices.

### **Common Area / Quiet Area** – 2<sup>nd</sup> floor (969 sq.ft. / 90m<sup>2</sup>)

This area would house a study space for students and also have quiet study cubicles for students who need to focus without distractions. Tutoring seminars would also be held here. Also need to include a water feature. This comes from a teaching we received from an Elder in which water symbolizes women and fire symbolizes men. A balance of both must be present. We have the firedome on the first floor, we thought it would be culturally appropriate to have a water feature in the quiet area for balance and tranquility.

- Primary Adjacencies:** 2<sup>nd</sup> floor administrative offices/classrooms
- Secondary Adjacencies:** TYP program
- Workshop feedback:** N/A
- Scouting Trip Results:** Every Gathering Place we visited that did not allocate a quiet study area for their students regretted this decision. Students told us while they liked the common area, it was difficult to study amidst the noise. We were advised that a quiet study area was very important.

### **Commons Area / Computer Area** - 1<sup>st</sup> floor (1076 sq.ft. / 100m<sup>2</sup>)

This area will hold several distinct functions. Firstly, it will provide a social space for students and visitors; a place where students can meet, relax, and entertain friends when not studying or in class. It will be an informal gathering space for all students to meet and mingle. One of the features of the Knowledge Commons will be an honouring wall to respect the ones who have contributed to the success of Indigenous students within the University. There will be a central focal point featuring a firedome much like the one in SUB.

This space can support approximately 15-20 computers. A printer and photocopier will be available and located at reception.

- Primary Adjacencies:** Gallery/Exhibition area/Aboriginal Student's Council Office  
**Secondary Adjacencies:** Connection through to Education North building and other student common areas.  
**Workshop feedback:** The Knowledge/Resource Centre is not intended as a replacement or source of duplication for existing U of A library materials, artifacts, or Art collection. Its function is to enhance the opportunity for students to access and research Indigenous culture  
**Scouting Trip Results:** All of the Gathering Places we visited had this type of area. It was a constant vibrant hub of activity (with the exclusion of Trent) where students socialized. While there are areas within Education North that are available for students to socialize, we believe it's imperative to have a distinct (separate but not exclusive) space for Indigenous students to call their own. The adjacent area should be the reception area to assist visitors and students if necessary.

### **Gallery/Exhibition** – 1<sup>st</sup> floor (538 sq.ft. / 50m<sup>2</sup>)

The Gallery Space, connected to the Knowledge Commons Area will function as a flexible exhibition space to accommodate a wide range of exhibits, displays, artifacts, and presentations over the course of the year. This space will enable Indigenous communities and students to raise the awareness of traditional and modern art and for all visitors to the Gathering Place. The Gallery is not intended as a static exhibition space housing current art and artifacts held in the University of Alberta collections.

Space will also be allocated to create a form of 'community wall', an interpretive and inspirational wall that features the history and stories of the previous generations. This installation could be in the form of a digital video wall.

- Primary Adjacencies:** Knowledge Commons Area/Entrance/Reception  
**Secondary Adjacencies:** 2<sup>nd</sup> floor administrative offices/Lockers/Washrooms  
**Workshop feedback:** This space should be widely accessible for pedestrian passersby, with the ability to showcase Aboriginal art and crafts to the general campus population.  
**Scouting Trip Results:** Art was regularly integrated all throughout the Gathering Spaces we looked at. There was no singularly specified room for exhibition space. Art was always everywhere.

**Gallery/Exhibition Storage** - 1<sup>st</sup> floor (100 sq.ft. / 10m<sup>2</sup>)

This will be a modest storage area required for storing material necessary for setting up a variety of displays throughout the year.

- Primary Adjacencies:** Knowledge Common Area/Gallery/Exhibition area  
**Secondary Adjacencies:** Change rooms/Washrooms  
**Workshop feedback:** N/A  
**Scouting Trip Results:** Lack of storage was one of the biggest challenges that many of the Gathering Places had to overcome.

**III. ADMINISTRATIVE 1st FLOOR** – (6 offices)

**Counselor/Social Worker Office** (120 sq.ft. / 11m<sup>2</sup>)

This office space houses Aboriginal Student Services Counsellor/Social Worker

- Primary Adjacencies:** 1<sup>st</sup> floor administrative offices/Great Hall  
**Secondary Adjacencies:** Kitchen/Coffee Room/Washrooms/Reception  
**Workshop feedback:** N/A  
**Scouting Trip Results:** All the Gathering Places we visited had these offices set aside.

**Aboriginal Student Advisor Office** (120 sq.ft. / 11m<sup>2</sup>)

This office space houses Aboriginal Student Services Advisor.

- Primary Adjacencies:** 1<sup>st</sup> floor administrative offices/Great Hall  
**Secondary Adjacencies:** Kitchen/Coffee Room/Washrooms/Reception  
**Workshop feedback:** N/A  
**Scouting Trip Results:** All the Gathering Places we visited had these offices set aside.

**Elder Office / Lounge** (215 sq.ft. / 20m<sup>2</sup>)

This space houses the resident Elder. This area will function in two ways; a quiet resting area for Elders but also could be used as an Elder meeting area.

- Primary Adjacencies:** 1<sup>st</sup> floor administrative offices/Great Hall  
**Secondary Adjacencies:** Kitchen/Coffee Room/Washrooms/Reception  
**Workshop feedback:** N/A  
**Scouting Trip Results:** All the Gathering Places we visited had offices for their Elders. Elders often travelled from a distance and needed a quiet, private space to rest and meditate. This area was utilized for this purpose.

**Faculty or Aboriginal Liaison Office** (120 sq.ft. / 11m2)

This temporary office space housed a visiting prof/faculty member/visiting scholars.

- Primary Adjacencies:** Student Commons Area/Gallery/Offices of ASC/Visiting faculty
- Secondary Adjacencies:** Washrooms/Reception
- Workshop feedback:** N/A
- Scouting Trip Results:** Most Gathering Places found that having a visiting scholar or visiting faculty office enhanced student learning and success. It not only provided an accessible resource for the students, but gave visiting scholars/profs/faculty an opportunity to meet informally with the student body. This also provided unique opportunities for both non-Indigenous and Indigenous students that would not normally frequent the Gathering Place.

**Aboriginal Student Association Office** (120 sq.ft. / 11m2)

This space will be dedicated to the Aboriginal Student's Association only.

- Primary Adjacencies:** Computer lab/Common Area/Gallery
- Secondary Adjacencies:** Washrooms/Reception
- Workshop feedback:** N/A
- Scouting Trip Results:** Every single Gathering Place had a dedicated space for their similar Aboriginal student association.

**III. ADMINISTRATIVE - 2nd FLOOR**

**TYP Coordinator Office** (120 sq.ft. / 11m2)

This office space directly adjacent to the TYP area would be for the TYP Coordinator.

- Primary Adjacencies:** 2<sup>nd</sup> floor administrative offices/ Classrooms/TYP area
- Secondary Adjacencies:** Quiet Area
- Workshop feedback:** N/A

**Administrative Assistant Office** (120 sq.ft. / 11m2)

This area will be a smaller informal reception area for the Aboriginal Initiatives Office Assistant.

- Primary Adjacencies:** 2<sup>nd</sup> floor administrative offices/ Classrooms/TYP area
- Secondary Adjacencies:** Quiet Area
- Workshop feedback :** N/A

**Director of Aboriginal Student Services Centre Office (ASSC) (120 sq.ft. / 11m<sup>2</sup>)**

This area will provide office space for the Director of ASSC.

**Primary Adjacencies:** 2<sup>nd</sup> floor administrative offices/ Classrooms/TYP area  
**Secondary Adjacencies:** Quiet Area  
**Workshop feedback:** N/A

**Special Advisor to the Provost (or similar position) Office - (120 sq.ft. / 11m<sup>2</sup>)**

This area will provide office space for the Special Advisor to the Provost (or a similar position).

**Primary Adjacencies:** 2<sup>nd</sup> floor administrative offices/ Classrooms/TYP area  
**Secondary Adjacencies:** Quiet Area  
**Workshop feedback:** N/A  
**Scouting Trip Results:** The Special Advisor to the Provost or a similar position worked in tandem with the Director of ASSC (or other similarly named position) and held an office within the Gathering Place.

**Transition Year Program Room 2nd floor (860 sq. ft / 80m<sup>2</sup>)**

This area will provide a space for the Transition Year Program and house a small computer lab, coffee area and lockers. Directly adjacent to the TYP area would be an office for the TYP Coordinator.

**Primary Adjacencies:** 2<sup>nd</sup> floor administrative offices/ Classrooms  
**Secondary Adjacencies:** Quiet Area  
**Workshop feedback:** N/A

## V. BUILDING SERVICES

The building services are typical for support of a facility of this size and function. More detailed design of building systems will enable the consultant team to further develop these components. These will include a mechanical room, electrical room, server room, washrooms, change rooms, caretaker room, and an internal loading dock.





## VI. PROGRAMMED OUTDOOR SPACES

Throughout workshop discussions, the importance of access to outside spaces was strongly reinforced. The intent of the exterior spaces is to function as an extension of the indoor spaces as events of varying scale occur in the Gathering Place, as well as providing areas for activities that have been traditionally held outside. These exterior components of the Gathering Place are integral to the success of the Programme as they enable the Gathering Place to more accurately reflect the spiritual nature of Indigenous culture, and the connection to the land.

### **Elders' Rooftop Garden** - (650 sq. ft. / 60m<sup>2</sup>)

This space will provide an area for contemplation, rest, quiet discussion, mentoring, etc. for the Elders and visiting guests in residence. The intention will be to provide private outdoor space for Elders, students and/or visiting guests can retreat from the ongoing activities of the campus and Gathering Place.

**Primary Adjacencies:** Rooftop/courtyard

**Workshop feedback:** N/A

### **Rooftop Courtyard** - (1884 sq. ft. / 175m<sup>2</sup>)

This area will provide a place where smaller outdoor gatherings/eating can occur. The area will allow for moderate sized groups to gather for meals, socials, and an opportunity to connect to the outdoors.

**Primary Adjacencies:** Elders Rooftop Garden

**Scouting Trip Results:** There were several Gathering Spaces that incorporated and outdoor area designed for smaller outdoor ceremonies, teachings and gatherings.

## SUMMARY OF LESSONS LEARNED

- Offices of the TYP Coordinator, Director and Special Advisor should be larger than 100 sq. ft. to accommodate a more intimate setting - (2-3 person) meetings in their office.
- Non gendered specific bathrooms.
- The ability to perform pipe ceremonies and smudging ceremonies.
- Special areas should be designated to support private conversations.
- Teachings were always incorporated into the building.
- Security and safety for the students in this highly accessible building and student access to the Aboriginal Student Association office needs to be considered.

Of interest would be to have a "Living Cultures Room" dedicated to serve artists for small carving projects, craft activities, storage of ceremonial materials.

## 1.2 PROGRAMME AREA

The original proposed programme requirements were derived from a series of workshops with primary stakeholders and user groups in 2008. This included Aboriginal students, student group representatives, faculty members, Elders, community partners, University representatives, members of the Aboriginal Initiative Working Group, and the design team. The revised programme requirements were based on the original document but also incorporate the operational input of Tracy Bear and Shana Dion from their tour of similar facilities and reflect the numerous existing amenities contained in the Education Building which will be physically connected to this Facility.

The process of determining requirements involves understanding who the end-users will be, the activities, scheduling and frequency of use, and the projected growth in demand. Groups were asked to objectively identify their needs, rather than how large a space they might desire. Functional relationships, spatial adjacencies, and flexibility of spaces were discussed with stakeholders to ensure a programme is developed that accommodate the stakeholders' goals. The proposed functional programme describes a common vision for the Gathering Place that embodies a holistic, functional, and cohesive whole.

The following chart evaluates the net program areas of the Functional Programme. The Building Gross Factor that is used is 35% of the net area. This factor makes area allowances for internal corridors, wall thicknesses, stairs, structure, services spaces, washrooms etc. In addition to the Building Gross Factor, an allowance of 10% of the net area is given for Building Programme Contingencies. This factor allows for the addition of any programme elements that may arise further into the design process. These program elements may be a result of a continuation of research and dialogue between the consultant team and user groups as the project moves forward, such as operational support, administration offices, and cultural spaces. Therefore, the combined total building gross up, when considering a complete building, is estimated at 45%.

CURRENT GATHERING PLACE PROGRAMME

	No. Req'd	Unit Area(m2)	Total Area(m2)	Total Area SQ.FT.
<b>I. CULTURAL SPACE</b>				
Great Hall/Ceremonial (250 Banquet Capacity)	1	425	425	4,575
Gallery/ Exhibition	1	50	50	538
Mediation Space/Entrance	1	50	50	538
Coat Room	1	10	10	108
Gathering Space Storage	1	45	45	484
Gallery/ Exhibition Storage	1	20	20	215
Kitchen	1	50	50	538
Kitchen Storage	1	10	10	108
		<b>Total Area</b>	<b>660</b>	<b>7,104</b>
<b>II. KNOWLEDGE COMMONS</b>				
Computer Area/Social	1	100	100	1,076
Quiet Area/Study	1	90	90	969
Lounge/Reading/Gathering	1	80	80	861
Multi-Functional Classroom/Meeting Room		80	80	861
TYP Program Room	1	80	80	861
		<b>Total Area</b>	<b>430</b>	<b>4,628</b>
<b>III. ADMINISTRATIVE</b>				
Reception/ Information	1	15	15	161
Office - Support Staff	2	11	22	237
Aboriginal Liaison	1	11	11	118
Administrative Assistant	1	11	11	118
Aboriginal Student Advisor	1	11	11	118
Aboriginal Students Council	1	11	11	118
Counselor Office	1	11	11	118
ASSC Director	1	15	15	161
Transition Year Program Coordinator	1	11	11	118
Special Advisor	1	15	15	161
Elder's Room	1	20	20	215
		<b>Total Area</b>	<b>153</b>	<b>1,647</b>
<b>IV. BUILDING SERVICES - (To be confirmed)</b>				
Mechanical/Electrical Room		100	100	1,076
Water Metre Room			5	54
Server Room			5	54
Washrooms			80	861
Caretaker			10	108
		<b>Total Area</b>	<b>200</b>	<b>2,153</b>
<b>VI. PROGRAMME OUTDOOR SPACE(Not included in building sub-total)</b>				
Elders Garden	1	60	60	646
Rooftop Courtyard	1	175	175	1,884
		<b>BUILDING SUB-TOTAL</b>	<b>1,443</b>	<b>15,532</b>
		Building Gross Factor (35%)	505	5,436
		Building Programme Contingency (10%)	144	1,553
		<b>TOTAL PROJECT AREA</b>	<b>2,092</b>	<b>22,522</b>

CURRENT SHARED PROGRAMME  
WITH NORTH EDUCATION BUILDING

	CAPACITY	No. Req'd	Unit Area(m2)	Total Area(m2)	Total Area SQ.FT.	LOCATION
<b>I. COMMON AREAS SYNERGIES</b>						
Commons/Student Gathering	Varies	3	492	492	5,296	N.ED. BDLG.
Food Service	n/a	1	85	85	919	N.ED. BDLG.
Lecture Hall	215	1	270	270	2,906	N.ED. BDLG.
Classroom	26-62	9	40-115	480	5,167	N.ED. BDLG.
Industrial Arts Labs	Varies	2	VARIABLES	160	1,717	N.ED. BDLG.
Cultural Room	90	1	165	165	1,776	N.ED. BDLG.
Library/Study		1	243	243	2,613	N.ED. BDLG.
Mentor Rooms/Breakout Room		3	VARIABLES	78	839	N.ED. BDLG.
Digital Recording Studio		1	VARIABLES	30	323	N.ED. BDLG.
TV Sound Studio		2	VARIABLES	20	215	N.ED. BDLG.
Total Area				2,023	21,772	
<b>II. SHARED BUILDING SERVICES -TBD</b>						
Mechanical/Electrical Room	n/a		0	0	0	N.ED. BDLG.
Water Metre Room	n/a		0	0	0	N.ED. BDLG.
Exit Stairs	n/a		0	0	0	N.ED. BDLG.
Server Room	n/a		0	0	0	N.ED. BDLG.
Washrooms	n/a		0	193	2,077	N.ED. BDLG.
<i>Women - 27 fixture (Basement,Level 1, Level)</i>						
<i>Men - 14 fixture, 12 urinals (All Levels)</i>						
Total Area				193	2,077	
<b>III. OUTDOOR GATHERING AREA (Not included in the Building Sub Total)</b>						
Sweatlodge				0	0	DBG
Large Ceremonial Gathering - Outdoor				0	0	QUAD
Total Area				0	0	
<b>BUILDING SUB-TOTAL</b>				<b>2,216</b>	<b>23,849</b>	
Programmed Outdoor Space				0	0	
<b>TOTAL PROJECT AREA</b>				<b>2,216</b>	<b>23,849</b>	

Additional Programme Areas Located within the Education Building

* Library	1	2658	2,658	28,610	S.ED. BDLG.
* Gymnasium	1	3357	3,357	36,134	S.ED. BDLG.
* Classroom	8	40-115	552	5,942	N.ED. BDLG.

1.0 FUNCTIONAL PROGRAMME

The Gathering Place at the University of Alberta

ORIGINAL PROGRAMME FROM THE UAGP VISIONING AND PROGRAMMING STUDY 2009

	CAPACITY	No. Req'd	Unit Area(m2)	Total Area(m2)	Total Area SQ.FT.
<b>I. Cultural Space</b>					
Central Gathering Space - Indoor	300	1	350	350	3,767
<i>Student Gathering</i>			75	75	807
<i>Gallery/ Exhibition</i>			75	75	807
<i>Mediation Space/Entrance</i>			50	50	538
<i>Multi-Function</i>			40	40	431
<i>Coat Room</i>			10	10	108
			600	600	6,458
Gathering Space Storage	n/a	1	50	50	538
Gallery/ Exhibition Storage	n/a	1	25	25	269
Ceremonial Room/Healing Room	15	1	20	20	215
Elder/ Visitor Residence	1-2	4	48	192	2,067
Kitchen	varies	1	75	75	807
Kitchen Storage	n/a	1	15	15	161
Food Service	n/a	1	50	50	538
			Total Area	1,027	11,055
<b>II. Common Area</b>					
Lecture Hall	100	1	200	200	2,153
Family / Children's Area	50	1	50	50	538
Family Area Storage	n/a	1	10	10	108
Mentor Rooms/Breakout Room	2-8	4	10	40	431
Break Out Rooms	15-20	2	30	60	646
			Total Area	360	3,875
<b>III. Knowledge/Resource Centre</b>					
Knowledge Commons(Library, Computer, Research)	varies	1	100	100	1,076
Librarian Office	1	1	10	10	108
Break Out Rooms	2-6	4	6	24	258
Resource Centre Storage	n/a	1	10	10	108
Digital Recording Studio	10	1	20	20	215
			Total Area	164	1,765

	CAPACITY	No. Req'd	Unit Area(m2)	Total Area(m2)	Total Area SQ.FT.
<b>IV. Administrative</b>					
Reception/ Information	1	1	15	15	161
Office - Support Staff	1	2	11	22	237
Aboriginal Students Council	20	1	40	40	431
Aboriginal Student Services Centre(ASSC)	15	1	30	30	323
<i>Coordinator</i>	1	1	11	11	118
<i>Transition Year Program Coordinator</i>	1	1	11	11	118
<i>Mentoring Aboriginal Peers Program Coordinator</i>	1	1	11	11	118
<i>Aboriginal Recruitment Officer</i>	1	1	11	11	118
Office/Admin Assistant	1	1	11	11	118
Elder Services	1	1	11	11	118
			Total Area	173	1,862
<b>V. Building Services</b>					
Mechanical Room	n/a		150	150	1,615
Electrical Room	n/a		30	30	323
Water Metre Room	n/a		30	30	323
Server Room	n/a		50	50	538
Washrooms	n/a		200	200	2,153
Change Rooms	n/a		50	50	538
Caretaker	n/a		30	30	323
Loading Dock	n/a		35	35	377
			Total Area	575	6,189
<b>VI. Programmed Outdoor Space</b>					
Large Ceremonial Gathering - Outdoor	500	1	500	500	5,382
Cooking/Eating Area	100	1	100	100	1,076
Children's Play Area	100	1	100	100	1,076
Sweat Lodge Area	20	1	40	40	431
Elders Garden/Courtyard	40	1	80	80	861
Vehicle Drop Off	n/a	1			
			Total Area	820	8,826
			Building Sub-Total	2,299	24,746
			Building Gross Factor (35%)	805	8,661
			Building Programme Contingency (20%)	460	4,949
			<b>TOTAL BUILDING AREA</b>	<b>3,563</b>	<b>38,357</b>
			Programmed Outdoor Space	820	8,826
			Project Area	4,383	47,183
			Total Project Area with Future Growth (30%)	5,698	61,338

## 2.0 SITE CHARACTERISTICS

### 2.1 SITE CONTEXT



## 2.0 SITE CHARACTERISTICS

The Gathering Place at the University of Alberta

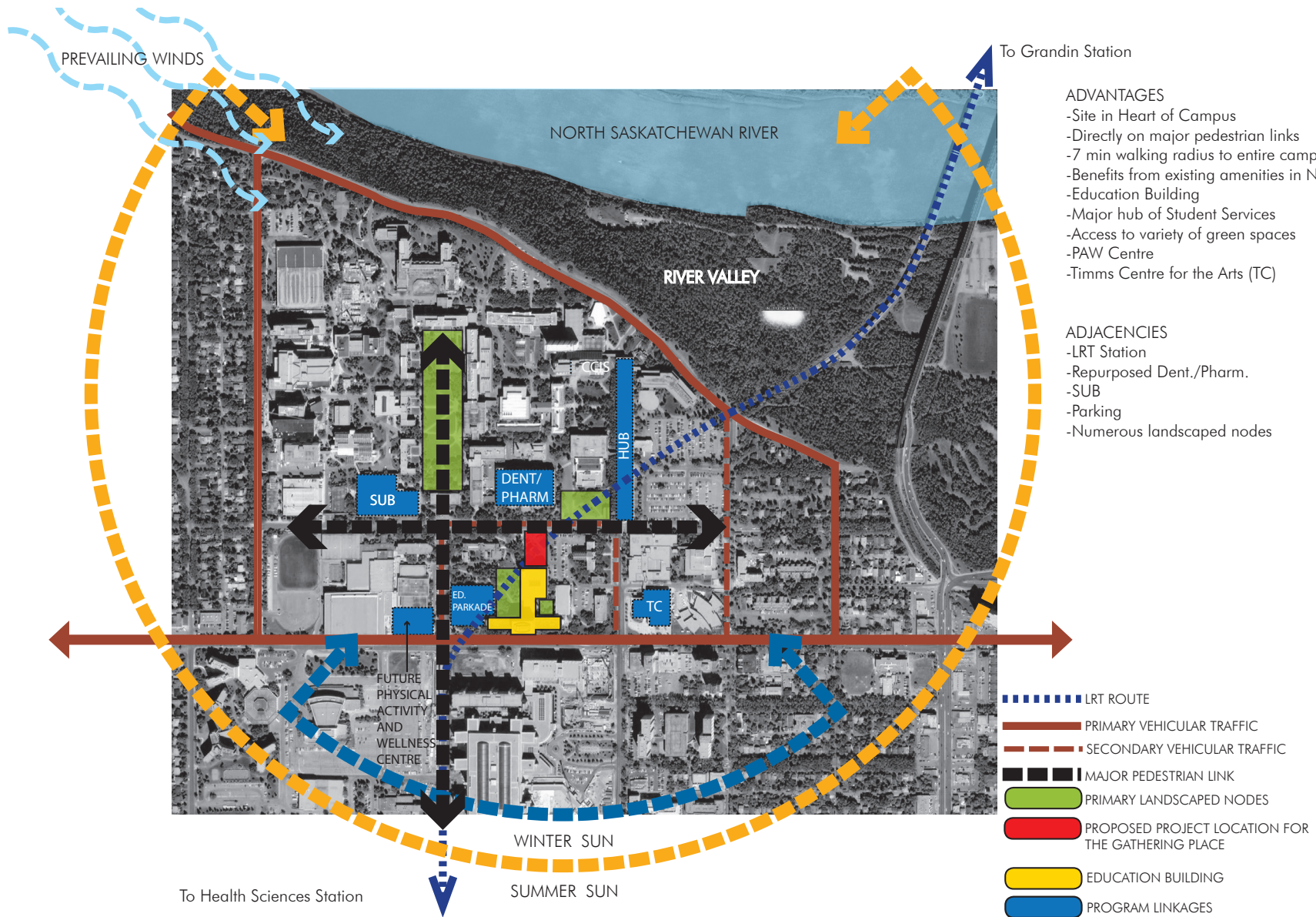



## 2.2 SITE PHOTOS



GREEN SPACE JUST WEST OF THE EDUCATION BUILDING



NORTH FACE OF EDUCATION BUILDING



VIEW LOOKING EAST ON 89 AVE FROM 114 STREET



VIEW LOOKING SOUTH TO PROPOSED SITE LOCATION FROM 89 AVE

2.0 SITE CHARACTERISTICS

The Gathering Place at the University of Alberta



STUDENTS GATHERING IN THE QUAD



GREEN SPACE SOUTH OF THE RUTHERFORD LIBRARY

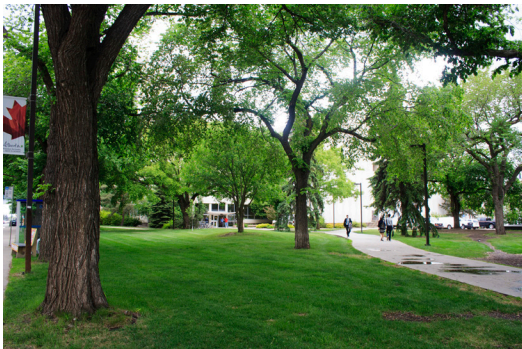

GREEN SPACE SOUTH OF THE EDUCATION BUILDING

### 2.3 PEDESTRIAN & TRAFFIC PLANS

PROPOSED PROJECT LOCATION  
FOR THE GATHERING PLACE

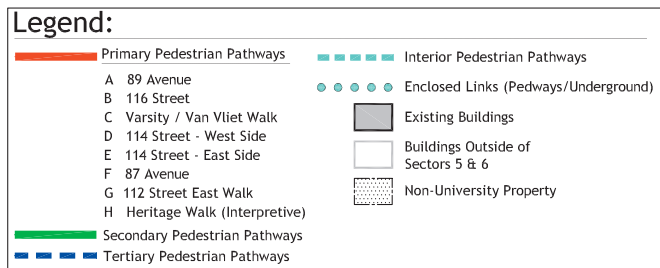
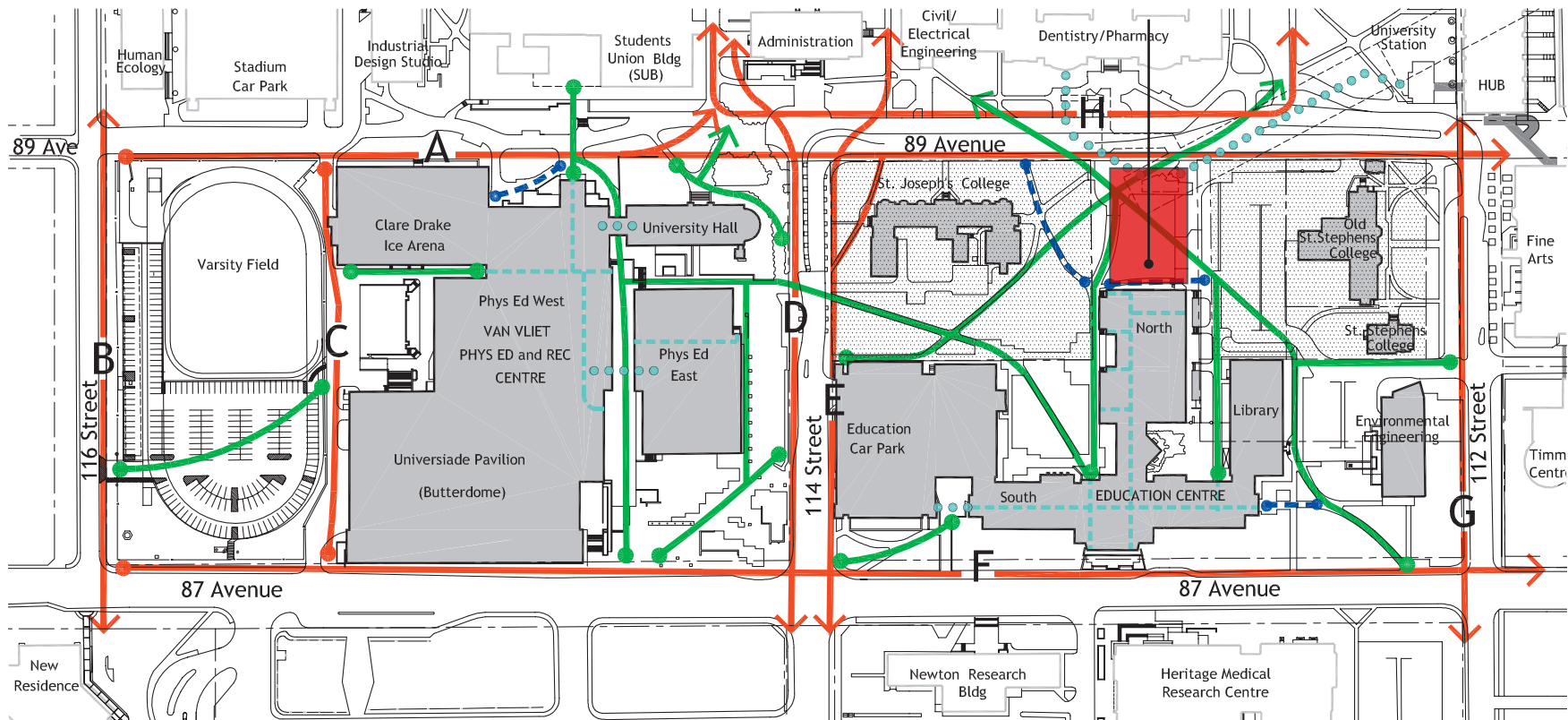

Figure 30 - EXISTING PATHWAYS (Pedestrian)

University of Alberta - Sectors 5 & 6

This figure is illustrative and intended for guideline purposes

November 2005

2.0 SITE CHARACTERISTICS

The Gathering Place at the University of Alberta

PROPOSED PROJECT LOCATION  
 FOR THE GATHERING PLACE

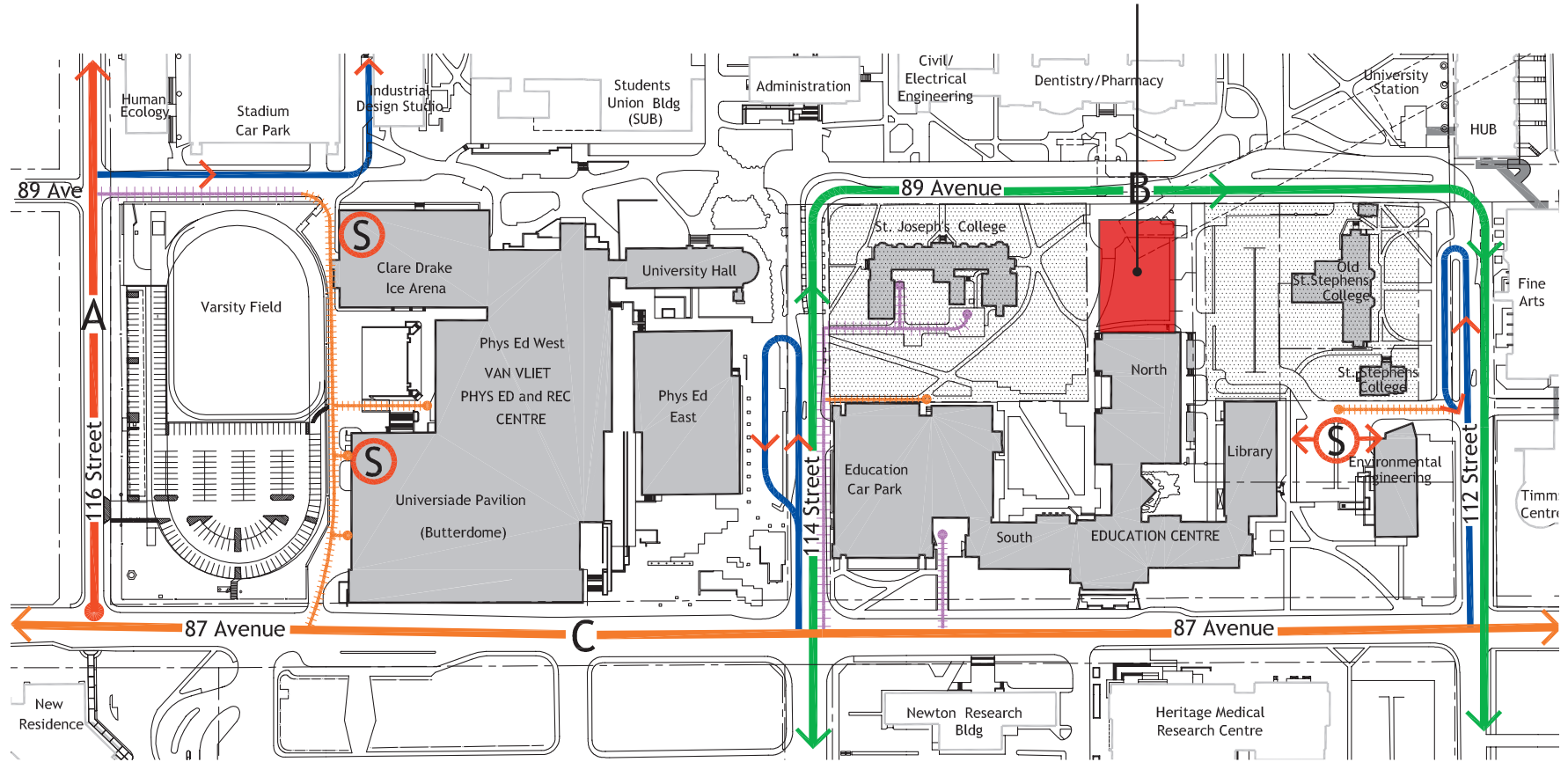

Figure 55 - PROPOSED VEHICULAR PATHWAYS  
 University of Alberta - Sectors 5 & 6

**Legend:**

Vehicular Pathways		Service Point Existing Drop-off / Parking Loops Existing Buildings Buildings Outside of Sectors 5 & 6 Non-University Property
	A 116 Street	
	B 114 St. / 89 Ave. / 112 St. Service & Transit Loop	
	C 87 Avenue	
	Pedestrian Pathways with Service Vehicle Access	
	Primary Service Vehicle Pathway	

This figure is illustrative and intended for guideline purposes

November 2005

PROPOSED PROJECT LOCATION  
 FOR THE GATHERING PLACE

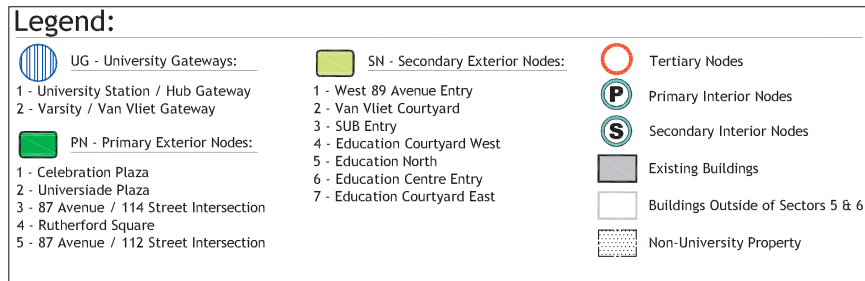
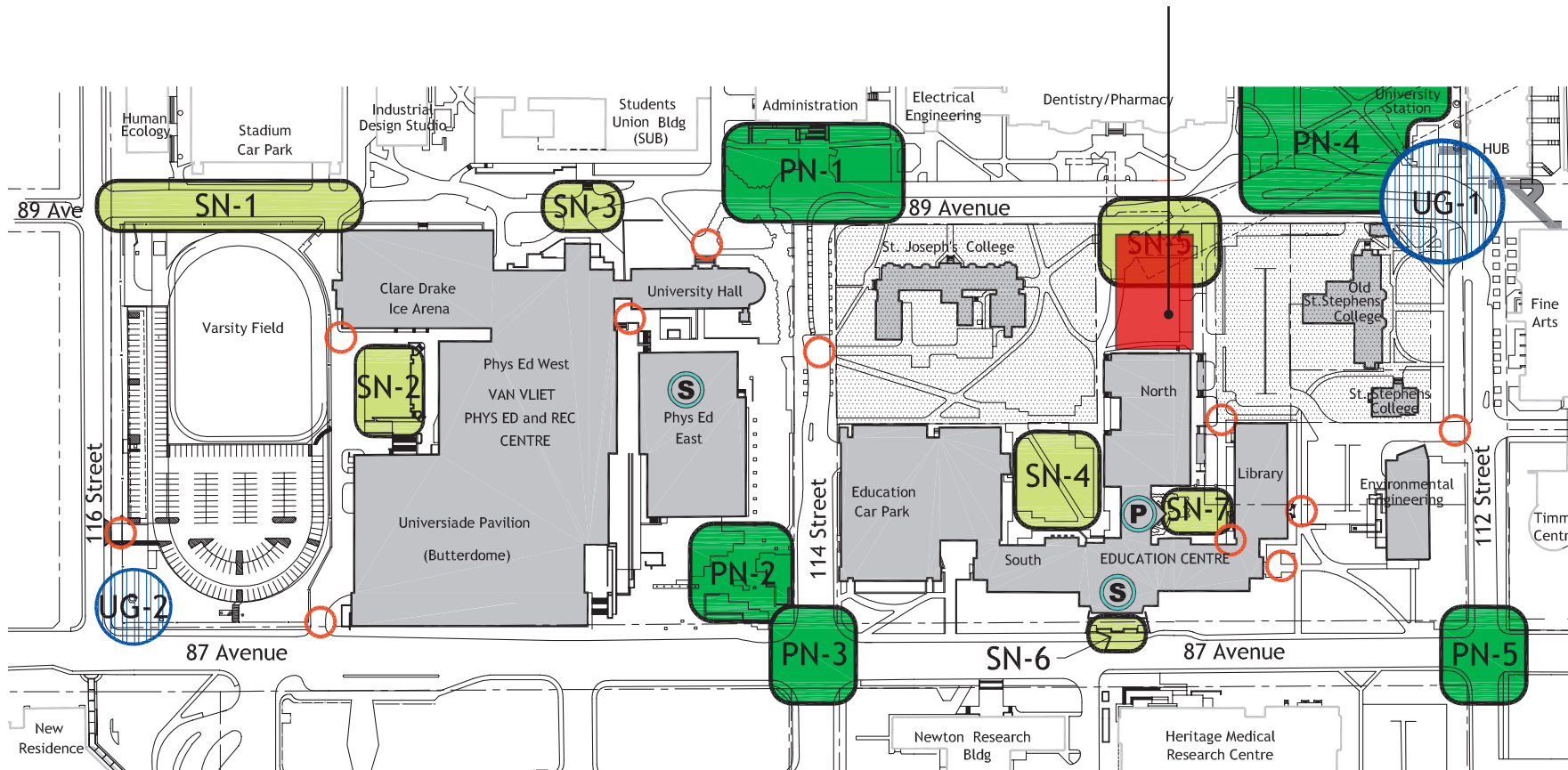

**Figure 44 - EXISTING NODES**  
 University of Alberta - Sectors 5 & 6

This figure is illustrative and intended for guideline purposes

November 2005

2.0 SITE CHARACTERISTICS

The Gathering Place at the University of Alberta

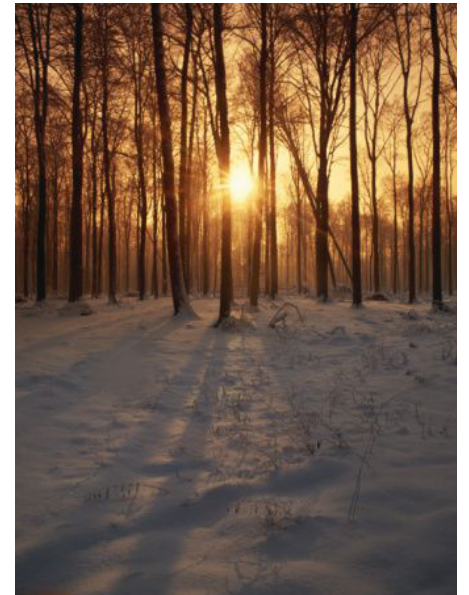

KINDERGARTEN SIGHARTSTEIN  
Kadawittfeldarchitektur



TRIPOLI CONGRESS CENTRE  
Tabanlıoğlu Architects



3.0 PRECEDENT STUDY



BC HOUSE  
GLR Architectos



CADENCE HOUSE  
Cadence



BRIAN C. NEVIN WELCOME CENTER  
Baird Sampson Neuert Architects

3.0 PRECEDENT STUDY

The Gathering Place at the University of Alberta





CAR PARK TERMINUS HOENHEIM-NORD  
Zaha Hadid Architects



TORONTO STEELES WEST STATION  
Will Aslop/RMJM/Stevens Group Architects



ROTHO BLAAS LIMITED COMPANY  
monovolume architecture + design

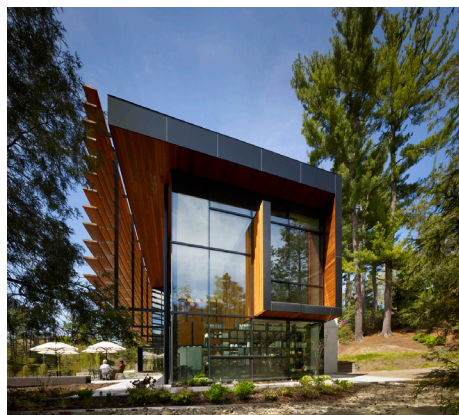

BRIAN C. NEVIN WELCOME CENTER  
Baird Sampson Neuert Architects



BALLARD LIBRARY AND NEIGHBORHOOD SERVICE  
Bohin Cywinski Jackson

3.0 PRECEDENT STUDY

The Gathering Place at the University of Alberta

DYNAMIC INTERIOR/EXTERIOR



BENNINGTON COLLEGE STUDENT CENTRE  
Taylor & Burns Architects



BRIAN C. NEVIN WELCOME CENTER  
Baird Sampson Neuert Architects



HELSINKI SEAFARERS' CENTRE  
ARK-house arkitehdit Oy

FAVRHOLM CONFERENCE CENTRE  
SeARCH

## LIGHT AND TRANSPARENCY

### 3.0 PRECEDENT STUDY

The Gathering Place at the University of Alberta

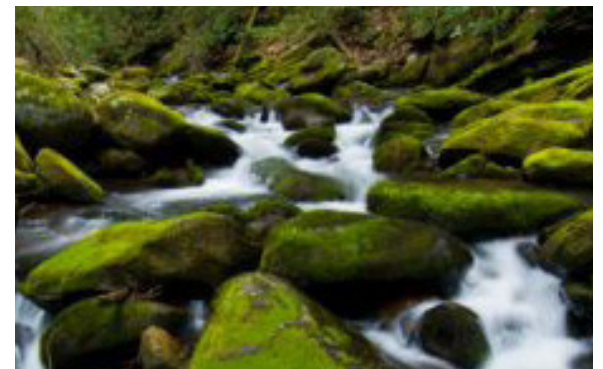

GARDEN ROOF TOP A SOHO LOFT  
DUB Studios



GARDEN ROOF TOP A SOHO LOFT  
DUB Studios



NATIVE CHILD AND FAMILY SERVICES OF TORONTO  
Levitt Goodman Architects



NATIVE CHILD AND FAMILY SERVICES OF TORONTO  
Levitt Goodman Architects



NATIVE CHILD AND FAMILY SERVICES OF TORONTO  
Levitt Goodman Architects

3.0 PRECEDENT STUDY

The Gathering Place at the University of Alberta

SITE PLAN - NTS

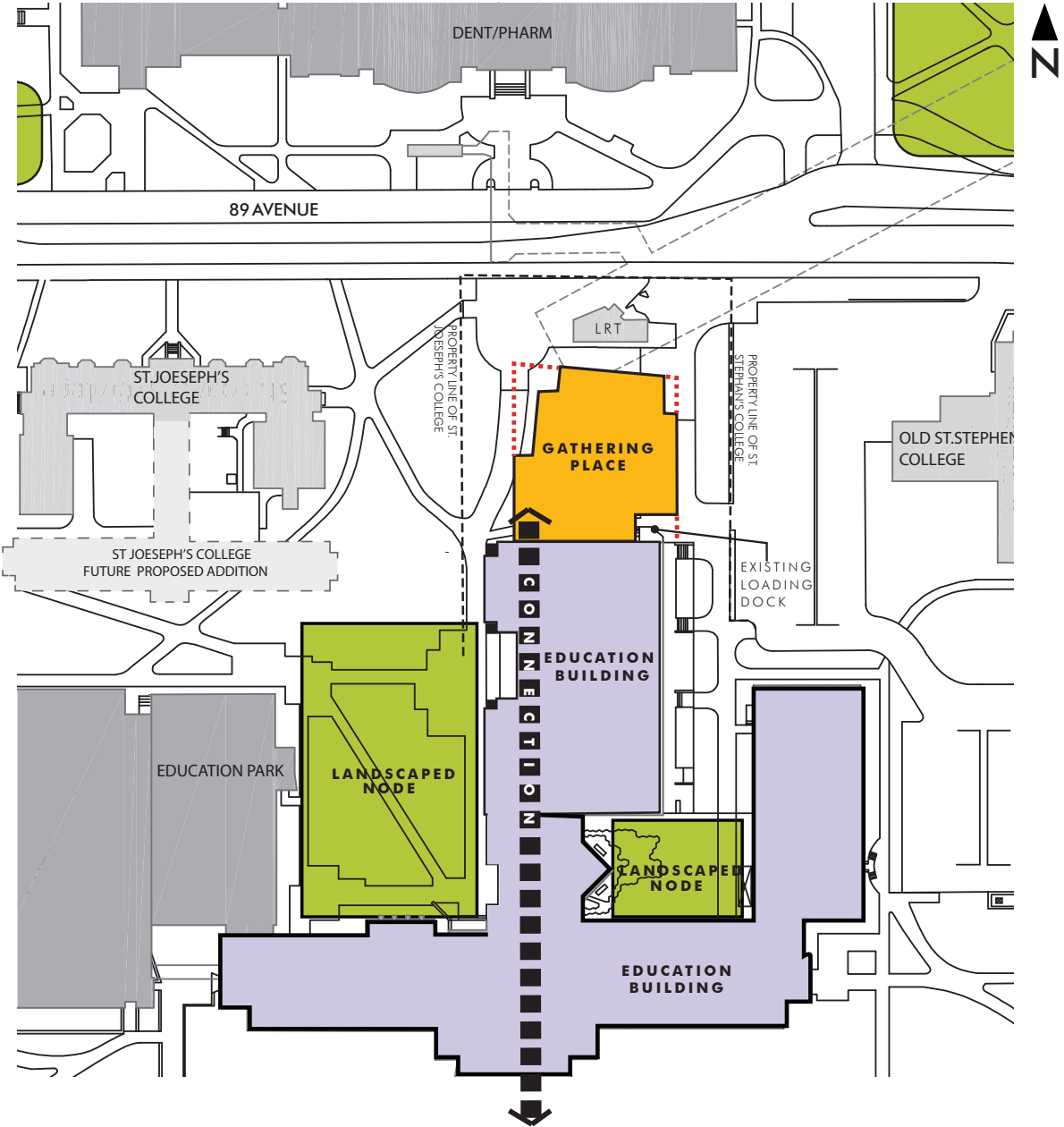

## 4.0 FUNCTIONAL PLANS

### 4.1 SITE PLAN

The location for The Gathering Place across from the Dentistry Pharmacy Building is unique on campus. The proposed redevelopment of the Dentistry Pharmacy Building intends to create a significant hub of student and administrative services in the center of the North Campus. The creation of The Gathering Place on this site builds upon this hub and further strengthens this area.

The careful placement of The Gathering Place on the site has allowed for the continuation of landscape and outdoor public circulation on both the North, West and East sides of the building. This enhances pedestrian movement in the immediate area and provides a key relationship between the ceremonial space in the Great Hall and the exterior on the East side of the Building. This is critical as entrance to major ceremonies is from the East relating to the position of the rising sun.

The conceptual floor plans have been developed to test key operational adjacencies and to examine the linkages between The Gathering Place and the North Education Building. This exercise has provided an enhanced understanding of key relationships within the building and between the building and the greater site. It has also been instrumental in the development of some preliminary concept images of the project that convey the scale and spatial qualities of The Gathering Place.

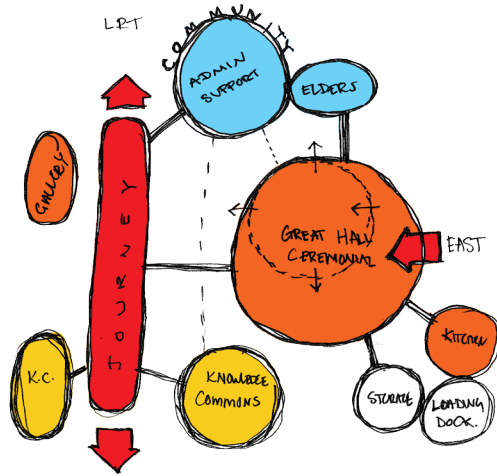

CONCEPTUAL PROGRAMMING DIAGRAM  
**FIRST FLOOR**

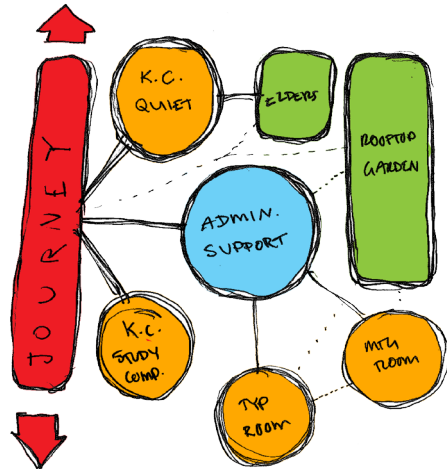

CONCEPTUAL PROGRAMMING DIAGRAM  
**SECOND FLOOR**

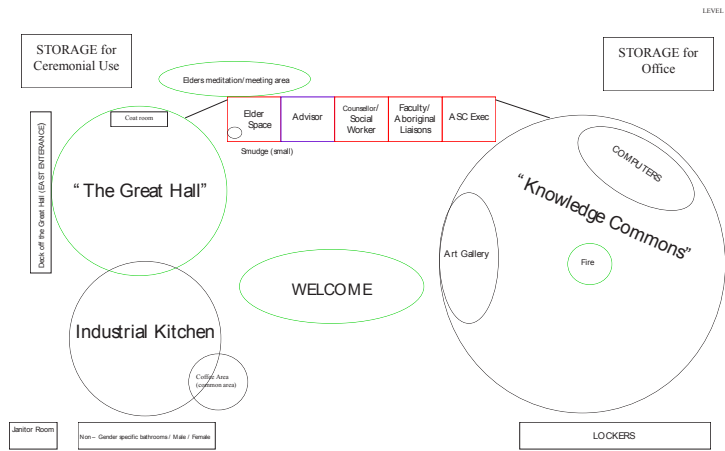

CONCEPTUAL PROGRAMMING DIAGRAM  
SHANA DION, DIRECTOR OF ASSC  
**FIRST FLOOR**

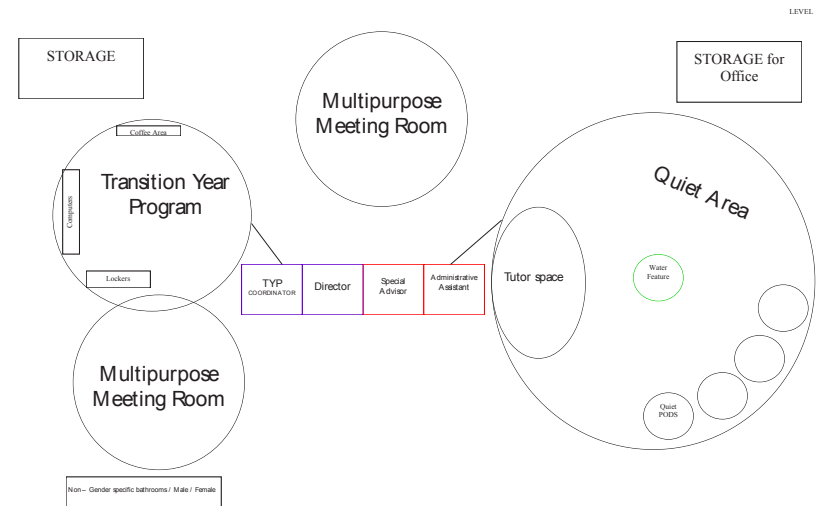

CONCEPTUAL PROGRAMMING DIAGRAM  
SHANA DION, DIRECTOR OF ASSC  
**SECOND FLOOR**



## 4.2 PROGRAMME RELATIONSHIPS

The following diagrams illustrate how the programmatic components relate to one another as well as identify spatial connections and adjacencies discussed in the workshops have been further developed by the client group and the design team. The diagrams show the relative sizes and potential configuration of spaces but do not represent a building floor plan. The diagrams are a temporal plate for preliminary architectural design which will be executed in more detail during the Schematic Design phase.

As a result of the past visioning sessions, the tours of similar facilities, and the overall understanding and knowledge that were gained through the initial design process created guiding principles that lead to the overall organization of the Gathering Place.

The diagram to the left completed by Shana Dion, Director of Aboriginal Student Services, represents her vision that was a direct result of understanding and knowledge that was gained from her own personal experiences, research, and tour of similar facilities. These concepts are intended to give direction to the design and help create guiding principles that will inform the process at all stages of development.

A further developed design for the project will be established through the schematic design phase. Through this process the design will be analyzed and various component parts of the program will be reconfigured. This will allow specific components to be positioned in the plan in ways that minimize disruption to other unaffected zones and which maximize the opportunities presented by the existing building. There will be a number of practical issues that will be addressed and further considered for example, the rooftop exhaust from the Kitchen.

### 4.3 GATHERING PLACE FLOOR PLANS

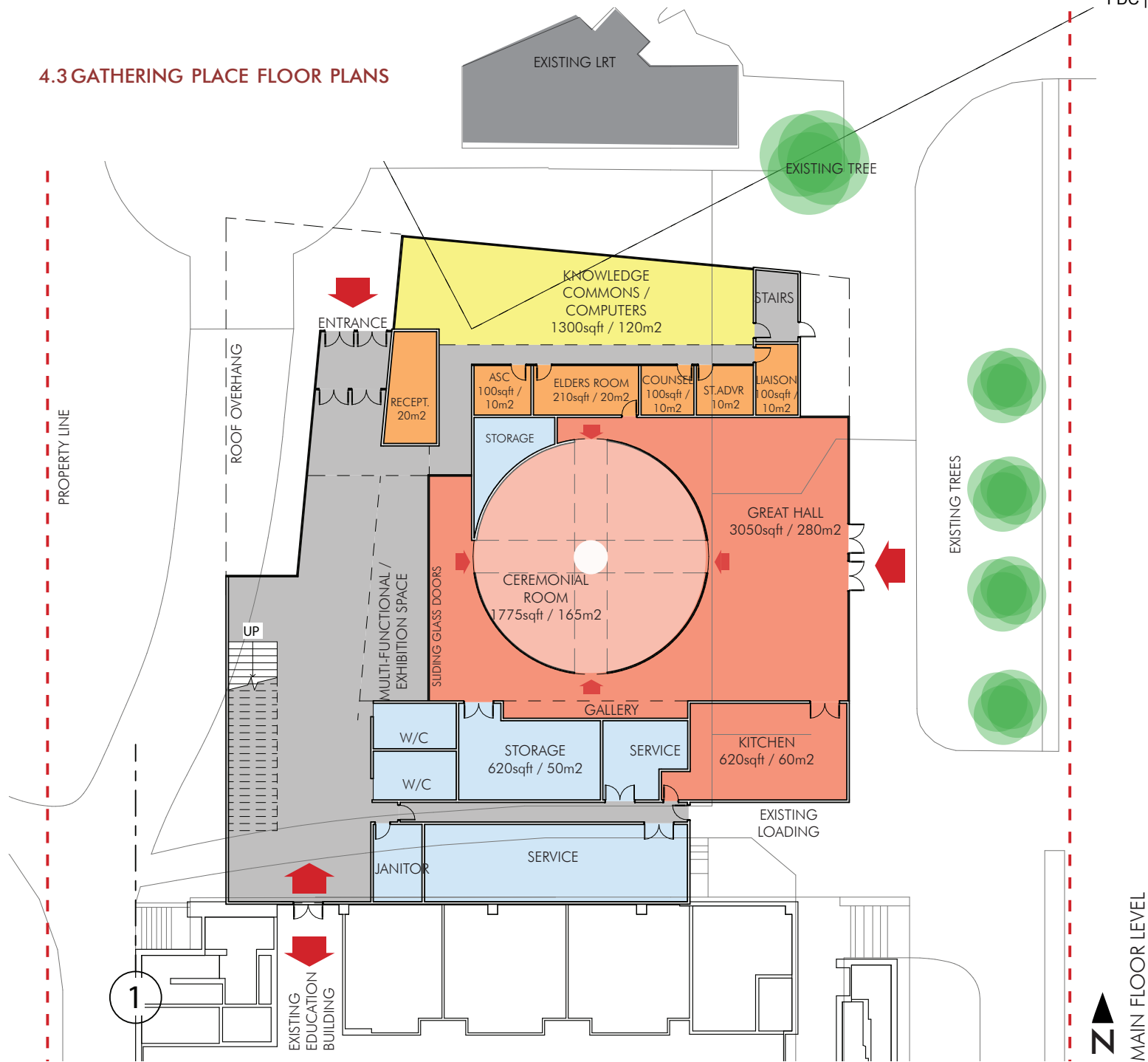

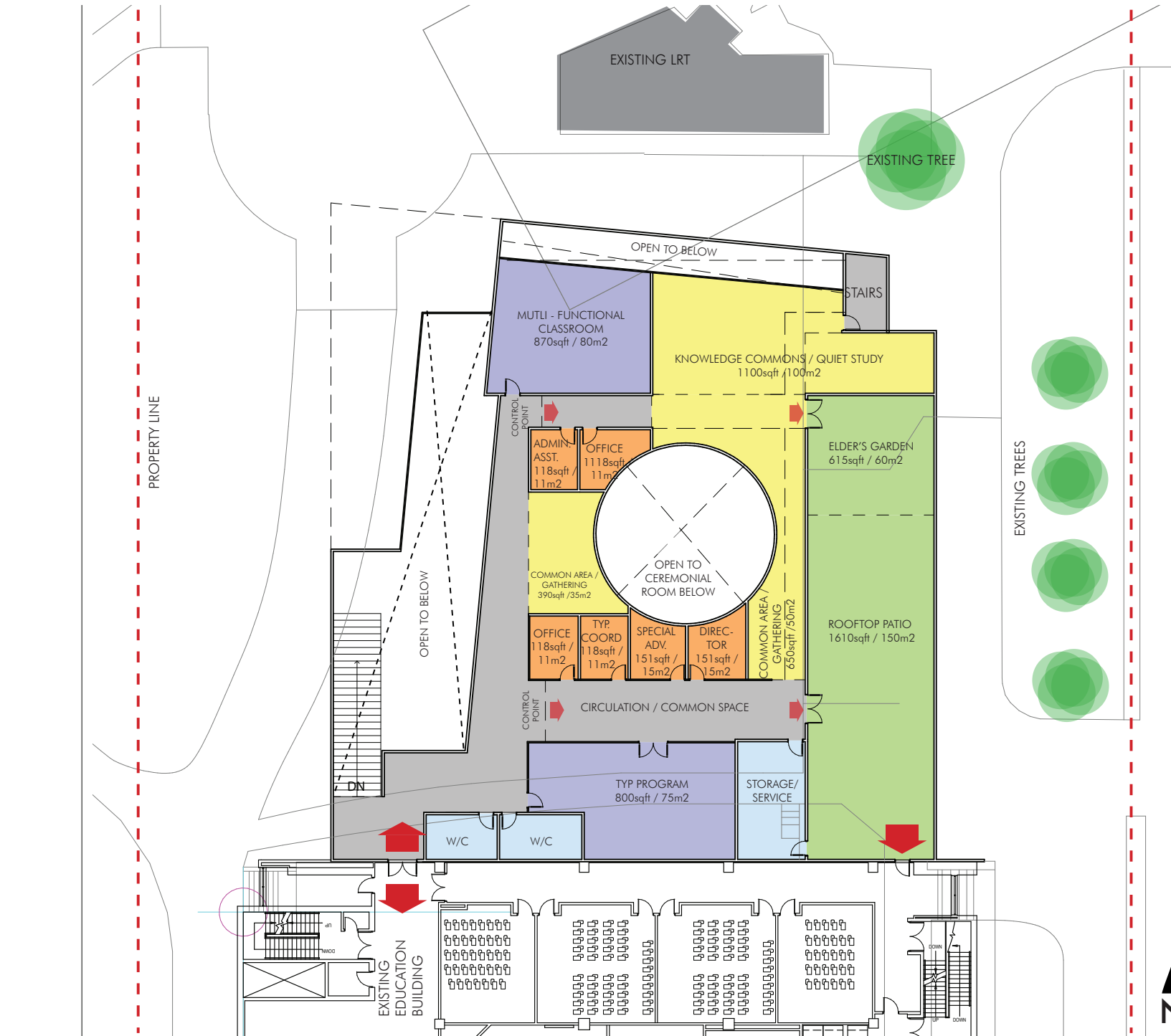

4.0 FUNCTIONAL PLANS

The Gathering Place at the University of Alberta

### 4.4 NORTH EDUCATION BUILDING FLOOR PLANS

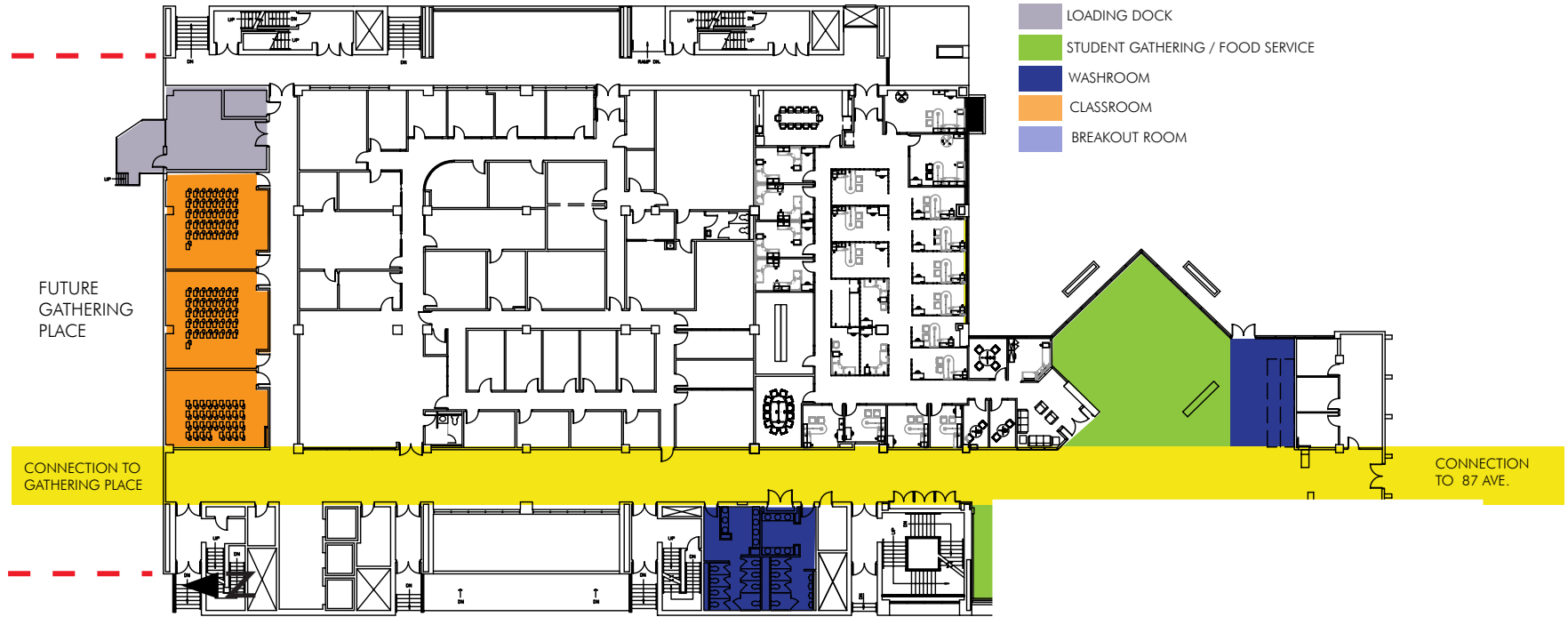

PROGRAMME SYNERGIES  
**MAIN FLOOR** - EDUCATION BUILDING

First Floor  
Education Centre - North  
Gross Area: 3208,50 sqm  
0 10 20 30 40ft.

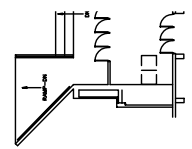

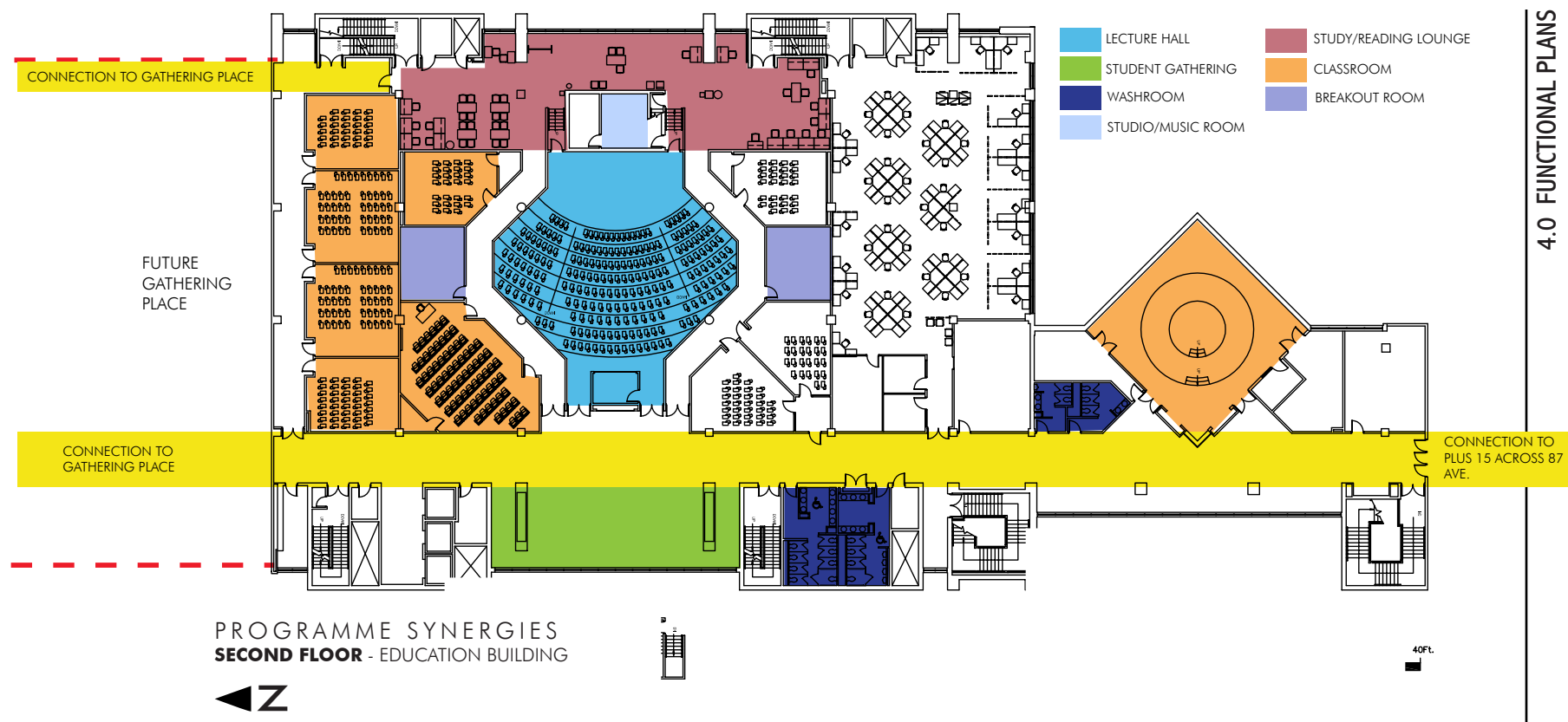

4.0 FUNCTIONAL PLANS

The Gathering Place at the University of Alberta

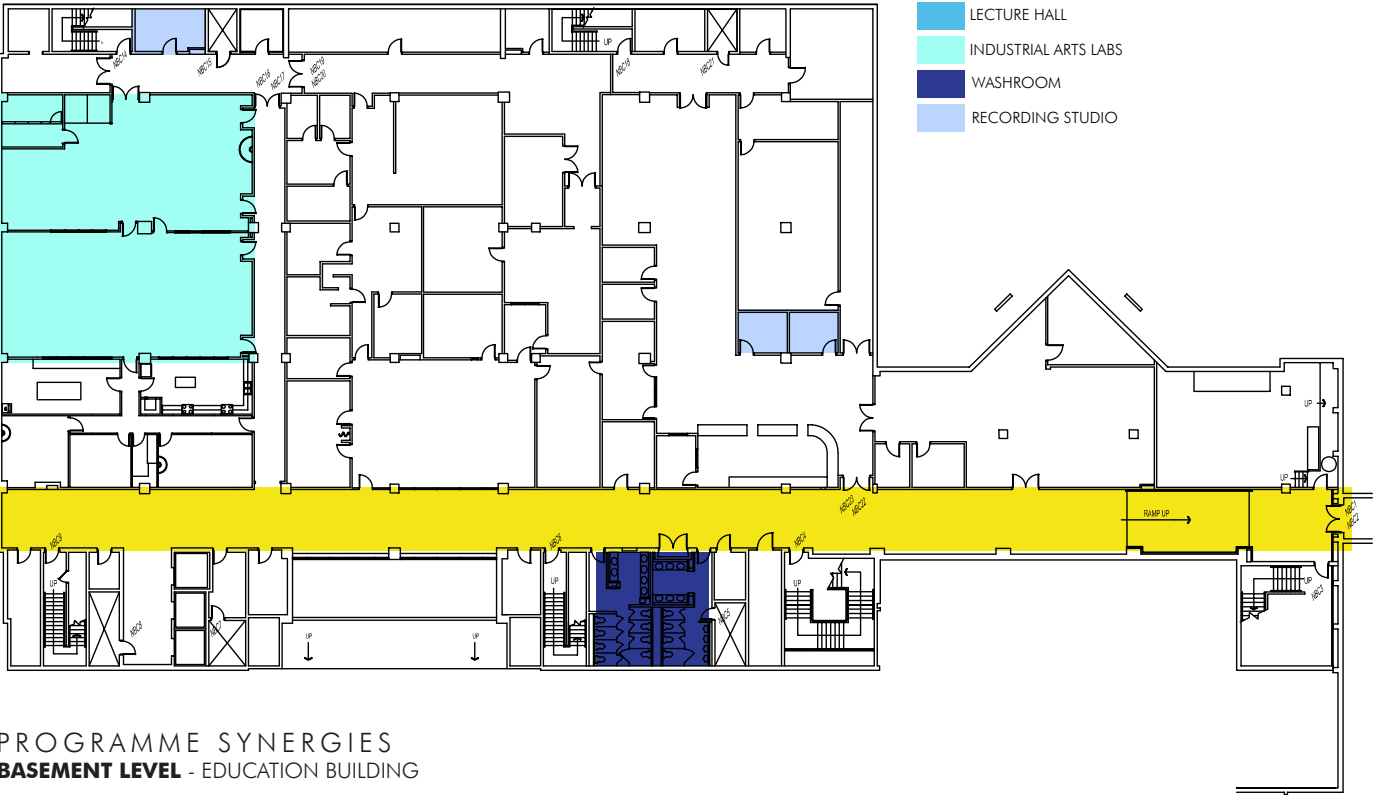

PROGRAMME SYNERGIES  
**BASEMENT LEVEL** - EDUCATION BUILDING



### NORTH EDUCATION BUILDING EXISTING PHOTOS

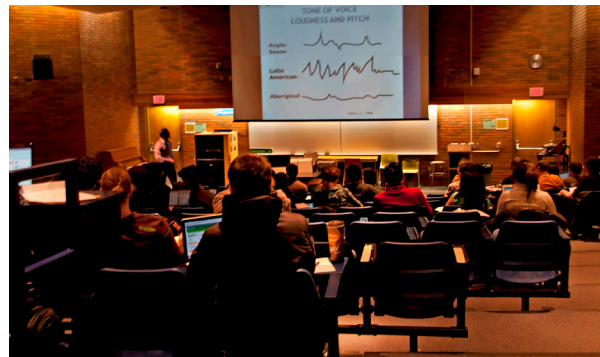

**LEVEL TWO** - LECTURE HALL



**LEVEL TWO** - CLASSROOM

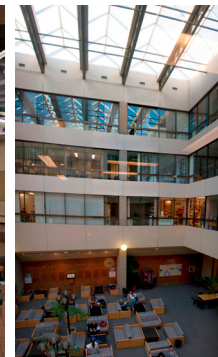

**LEVEL TWO** - STUDY/  
READING LOUNGE



**MAIN FLOOR** - STUDENT GATHERING / FOOD SERVICE

### 4.0 FUNCTIONAL PLANS

The Gathering Place at the University of Alberta



NORTH WEST PERSPECTIVE





EAST PERSPECTIVE

5.0 CONCEPT IMAGES

The Gathering Place at the University of Alberta



## 6.1 COUNCIL ON ABORIGINAL INITIATIVES AND STEERING COMMITTEE MEMBERSHIP

### **COUNCIL OF ABORIGINAL INITIATIVES**

#### **PERMANENT MEMBERS:**

- Carl Amrhein, Provost and Vice-President (Academic) (Co-Chair)
- Linda Hughes (term ended June 2012) new - Ralph Young; Chancellor (Co-Chair)
- Nathalie Kermoal (term ended June 2012) new - Brendan Hokowhitu; Dean of Native Studies
- Fern Snart; Dean of Education
- Frank Robinson; Dean of Students, Vice-Provost
- Gerry Kendal; University Registrar, Vice-Provost
- Tracy Bear; Special Advisor to the Provost (or successor position)
- Shana Dion; Director of Aboriginal Student Services Centre
- Freda Cardinal; Aboriginal Recruitment Officer appointed by the Registrar

#### **APPOINTED MEMBERS 2 YR TERMS:**

- Don Hickey (June 30th, 2013); One other Vice-President
- Both open (to be appointed by July 1, 2012, expires June 30th, 2014); Two additional Deans
- Ernie Ingles (June 30th, 2013); One additional Vice-Provost

#### **APPOINTED MEMBERS 3 YR TERMS:**

MAXIMUM OF 8 MEMBERS OF THE SENATE AND SENATE ALUMNI

- Ethel Blondin Andrews
- Dennis Callihoo
- Leith Campbell
- Leona Carter
- Lanny Der
- Louise Hayes
- Nona German
- Dan Vandermuelen

MAXIMUM OF 12 MEMBERS ENGAGED WITH ABORIGINAL ISSUES ON CAMPUS.

- Chris Andersen
- Catherine Anley
- Lisa Bourque Bearskin
- Clifford Cardinal
- Reginald Cardinal
- Anna Leah King
- Malcolm King
- Andrea Menard
- Gita Sharma
- Evelyn Steinhauer
- Shelly Gladue

MAXIMUM OF 3 EACH OF EXTERNAL & INTERNAL MEMBERS AS APPOINTED AND AGREED UPON BY THE CO-CHAIRS.

- Lorraine Breault
- Eric Newell
- Nathalie Kermod

**APPOINTED STUDENT MEMBERS (NO FIXED TERM):**

- One of each representative from current and recognized Aboriginal student organization, association or council
- One representative each from Graduate and Undergraduate Student Association

**STEERING COMMITTEE**

The Council on Aboriginal Initiatives (CAI) will have a smaller CAI Steering Committee that will serve as a working group to set the agenda and guide the larger discussions of the CAI.

**STEERING COMMITTEE PERMANENT MEMBERS:**

- Carl Amrhein; Provost and Vice-President (Academic) (Co-Chair)
- Linda Hughes; Chancellor (Co-Chair)
- Tracy Bear; Special Advisor to the Provost or (successor position)
- Shana Dion; Director of Aboriginal Student Services Centre

### **STEERING COMMITTEE APPOINTED MEMBERS:**

Two members engaged with Aboriginal issues on campus.

- Ernie Ingles
- Andrea Menard

Two external representatives

- Eric Newell
- Lorraine Breault

Two members of the academy

- Chris Andersen
- One opening currently

Dean

- Open

Resource

- Von Whiting

### **COUNCIL MEETINGS**

The CAI and the CAI Steering Committee will meet not less than three times per year at mutually scheduled times.

Agendas will be managed by the co-chairs. Normally, materials shall be circulated in advance to all members. In the case of urgent and important items that have not been placed on the agenda in advance, these may be added to the agenda on the determination of the co-chairs.

### **COUNCIL SECRETARIAT**

The Office of the Provost will provide secretarial support to the committee.

The Office of the Provost and Vice-President (Academic) will hold official records of the committee's deliberations. The records of the Committee will be subject to the provincial FOIPP legislation and comply with the records retention schedule of the Office of the Provost and Vice-President (Academic).



## 6.2 ACKNOWLEDGEMENTS

### University of Alberta Gathering Place Visioning and Programming Study 2009

Individuals who contributed to the University of Alberta Gathering Place Visioning and Programming Study 2009.

Eric Newell, University of Alberta, Chancellor  
Carl Amrhein, University of Alberta, Provost  
Derek Roy Brenneis, University of Alberta  
Tracy Bear Coon, University of Alberta  
Don Hickey, University of Alberta  
Mary Paul, University of Alberta  
Ben Louie, University of Alberta  
Leo Lejeune, University of Alberta  
Colette O'Brien, University of Alberta

Herb Belcourt, Aboriginal Initiative Working Group, Champion  
Al Benson, Aboriginal Initiative Working Group, Champion  
Wilton Littlechild, Aboriginal Initiative Working Group, Champion

Ella Arcand, Health Director, Yellowhead Tribal Council  
George Brereton, Elder, Blue Quills First Nations College  
John Brosseau, Superintendent, Boyle Street Education Centre  
Victor Buffalo, Chief of Samson Cree Nation  
Chester Cunningham, Founder of Native Counseling Services of Alberta  
Trevor Gladue, Board Chair, Northern Lakes College; Vice-President of Métis Nation of Alberta  
Maggie Hodgson, Founder and Executive Director of Nechi Institute on Alcohol and Drug Education  
Alex Janvier, Aboriginal Leading Canadian Artist  
Rita Martin, Athabasca Tribal Council Education Committee  
Cliff Supernault, Alberta Government Energy and Aboriginal Relations, Edmonton Housing Trust Fund  
Laurence Vermillion, Fort Chipewyan

Frank Robinson, Dean of Students  
Leona Carter, City of Edmonton  
Margaret-Ann Armour, Assoc. Dean of Science  
Janelle Morin, Students' Union  
Fay Fletcher, Public Health / Extension  
Marge Friedel, Métis Nation of Alberta  
Melissa Gillis, Aboriginal Student Services  
Chris Andersen, Faculty of Native Studies  
Val Napoleon, Faculty of Law and Native Studies  
Martha Campiou, Native Studies Cultural Advisor  
Earle Waugh, Family Medicine  
Sally Rice, Department of Linguistics / CILLDI  
Malcom King, Faculty of Medicine  
R.Lisa Bourque – Bearskin, Student of Nursing  
Jodi Stonehouse, Student  
Mahalia Villebrun, Student and ASC Executive  
Tanisha Moore, Registrar's Office  
Rodney McLeod, President of Aboriginal Student's Council  
Anita Molzahn, Dean of Faculty of Nursing  
Gurston Dacks, Acting Dean, Native Studies  
Nicole Hetu, Administrator, Aboriginal Healthcare Careers  
Ernie Ingles, Library/Museum/Archives/Press  
Doug Dawson, Ancillary Services  
Dennis Callihoo, Senate  
Ethel Blondin – Andrew, Senate  
Anna-Leah King, CILLDI  
Evelyn Stenhauer, ATEP  
Brenda Cameron, Nursing / ACADRE NEAHR  
Gerry Kendal, Registrar  
Dan Vandermeulen, Senate  
Cliffard Cardinal, Assistant Professor, Family Medicine  
Fern Snart, Education  
Frank Tough, Native Studies  
Shana Dion, General Manager, Aboriginal Student Services



### 6.3 POWERPOINT PRESENTATION BY TRACY BEAR AND SHANADION

## Visual References

# Gathering Place Scouting Trip 2012

- University of Manitoba, Winnipeg MB  
[Migizii Agamik – Bald Eagle House](#)
- Trent University, Peterborough ON  
[First Peoples House of Learning](#)
- University of British Columbia, Vancouver BC  
[First Nations House of Learning](#)
- University of Victoria, Victoria BC  
[First Peoples House](#)
- University of Vancouver Island, Nanaimo BC  
[Shq'aphut](#) – meaning Gathering Place in Hul'q'umi'num'

## I. Cultural Space

- Great Hall
- Industrial Kitchen
- Coffee Room
- Kitchen Storage
- Entrance Reception
- Coatroom

# Visual References

## Great Hall

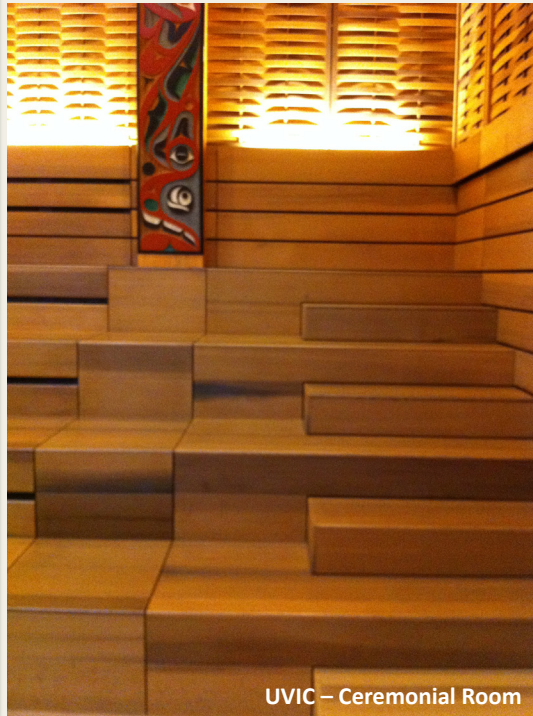

- Designed with cultural traditions in mind.
- Seating capacity of 300 +/
- Benches as well as floor seating
- Firepit/firedome to be integrated into the floor, so when not in use can be covered up.
- Must make a statement about the traditional peoples of this land.

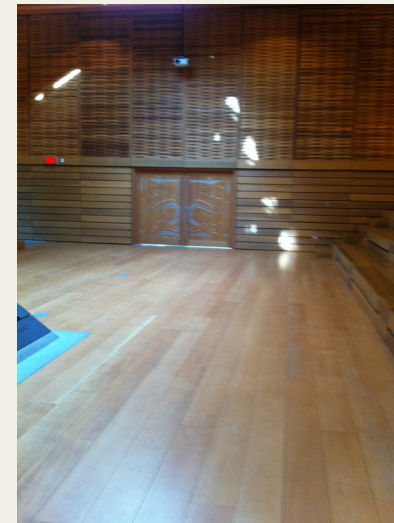

Visual References

Great Hall



**Visual References**

**Industrial Kitchen**



UBC – Kitchen

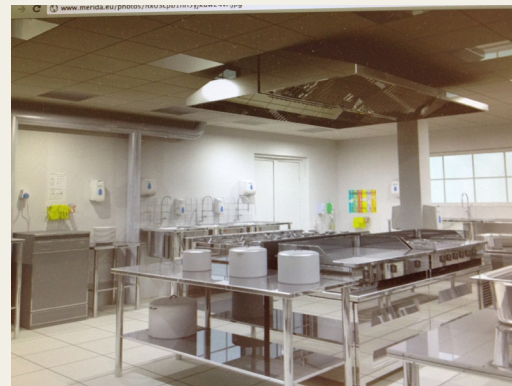

**6.3 APPENDIX**

The Gathering Place at the University of Alberta

# Visual References

## Entrance/Reception



# Visual References

## Entrance/Reception



Both Trent University and University of Manitoba had Gathering Places that are two story buildings. We learned that having a second floor – while a necessity – can also disconnect staff from each other and from students. Trent University the staff had an unfortunate disconnect with the students. This inviting staircase could be a possible design to bridge this gap.

# Visual References

## Knowledge Commons area/Great Hall





**Visual References**

## Entrance/Reception



University of Manitoba— Reception/entrance area

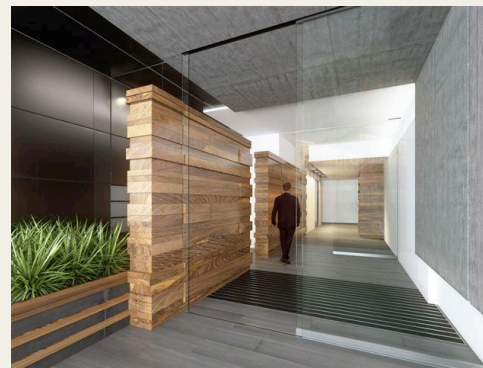

University of Manitoba— Reception/entrance area



University of Manitoba— Reception/entrance area

## II. Common Areas

- 2 Classrooms – 2<sup>nd</sup> floor
- Quiet Area – 2<sup>nd</sup> floor
- Knowledge Commons Area – 1<sup>st</sup> floor
- Gallery/Exhibition – 1<sup>st</sup> floor
- Gallery storage – 1<sup>st</sup> floor
- Computer Lab

# Visual References

## Knowledge Commons Area



University of Manitoba – Knowledge Commons area



### 6.3 APPENDIX

The Gathering Place at the University of Alberta

**Visual References**

Knowledge Commons



University of Vancouver Island – Knowledge Commons area

Computer Lab



# Visual References

## Gallery/Exhibition



### 6.3 APPENDIX

The Gathering Place at the University of Alberta

### III. Administrative - 1<sup>st</sup> floor

- Counselor/Social Worker Office
- Aboriginal Student Advisor Office
- Elder Office
- Elder Mediation/Lounge area
- Faculty or Aboriginal Liaison Office
- Aboriginal Student Association Office

# Visual References

## Offices

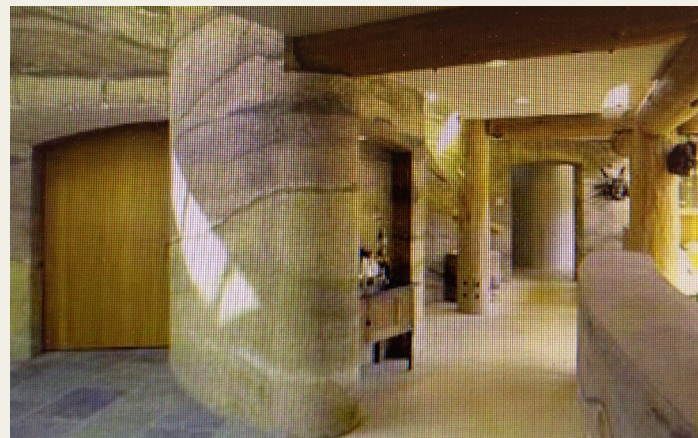

### III. Administrative – 2<sup>nd</sup> floor

- TYP Coordinator Office
- Administrative Coordinator Office
- Director of Aboriginal Student Services Centre Office
- Special Advisor to the Provost (or similar position) Office
- Transition Year Program Room



**Visual References**

**Ceremony Room**



**University of Manitoba– Ceremony Room**

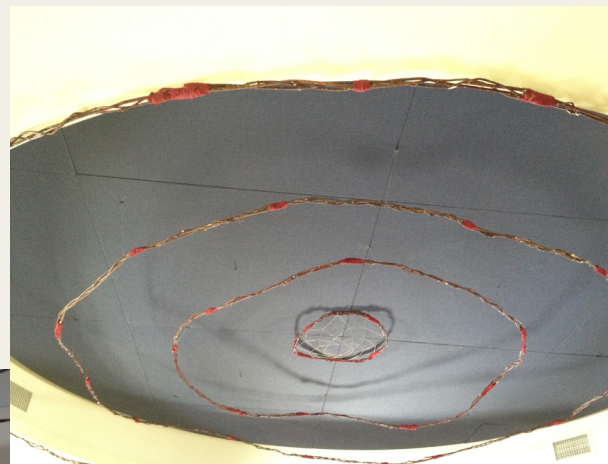

**Classroom chairs with buffalo cutouts – Trent**



## V. Programmed Outdoor Spaces

- Elder's Rooftop Garden
- Rooftop Courtyard

# Visual References

## Outdoor Spaces



UBC – Exterior



UBC – Exterior



Trent – Exterior

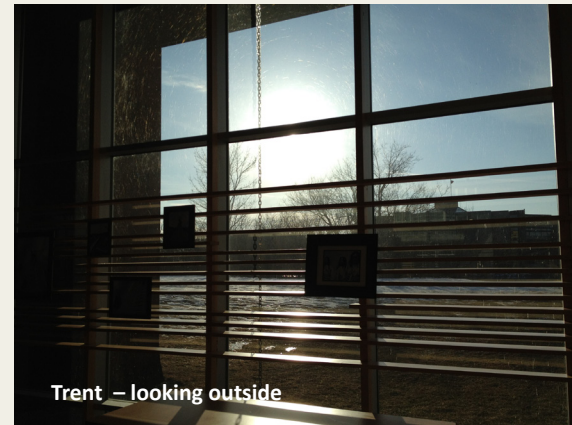

Trent – looking outside

**Visual References**

Exterior



# Visual References



## Exterior

These are buildings that incorporate rammed earth into their architecture. These structures are known as SIREWALL© (Structured Insulated Rammed Earth)

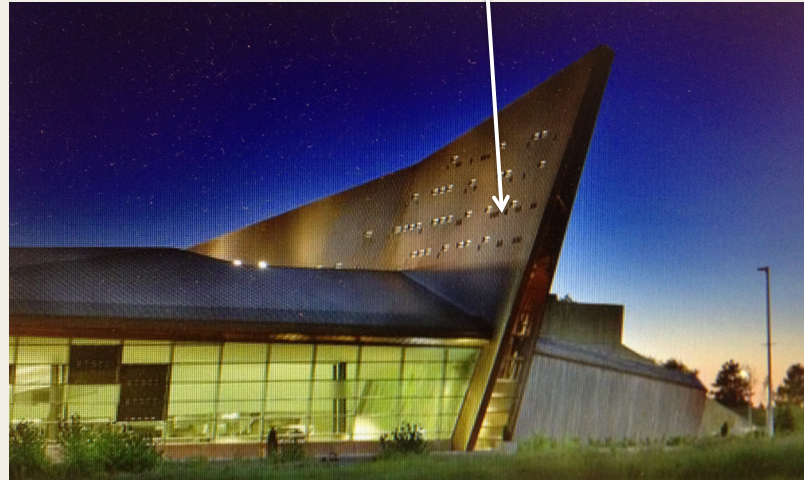

**Visual References**

Exterior



## 6.4 PRELIMINARY BUDGET

RESERVED FOR PRELIMINARY BUDGET